

02 - A PROPOSED MUGA + CABLEWAY AT CARROWTEIGE BALLINA CO MAYO

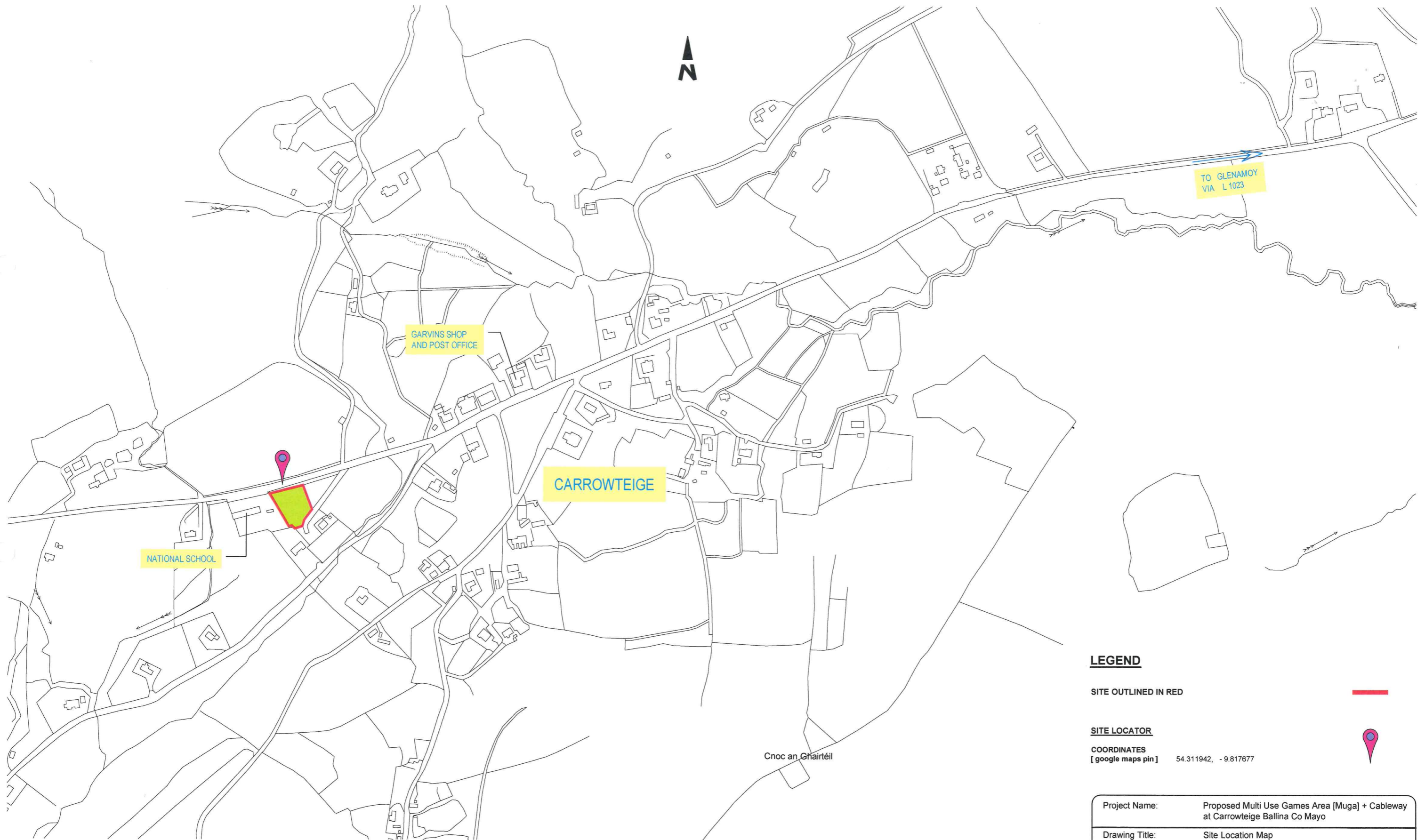

LEGEND

SITE OUTLINED IN RED



SITE LOCATOR

COORDINATES
[google maps pin] 54.311942, -9.817677



Project Name:		Proposed Multi Use Games Area [Muga] + Cableway at Carrowteige Ballina Co Mayo	
Drawing Title:		Site Location Map	
Drawing Status:		Tender	
Dwg By: DC	Date: March 2020	Dwg No: 02 - A	
	Scale: 1: 5000		
Ck By: PG	Sheet size: A3	Revision No: 0	

SITE LOCATION MAP

SCALE 1: 5000 @ A3

02 - B PROPOSED MUGA + CABLEWAY AT CARROWTEIGE BALLINA CO MAYO



01 TYPICAL MULTI USE GAMES AREA [MUGA] IMAGE [OR SIMILAR APPROVED / EQUIVALENT MUGA]

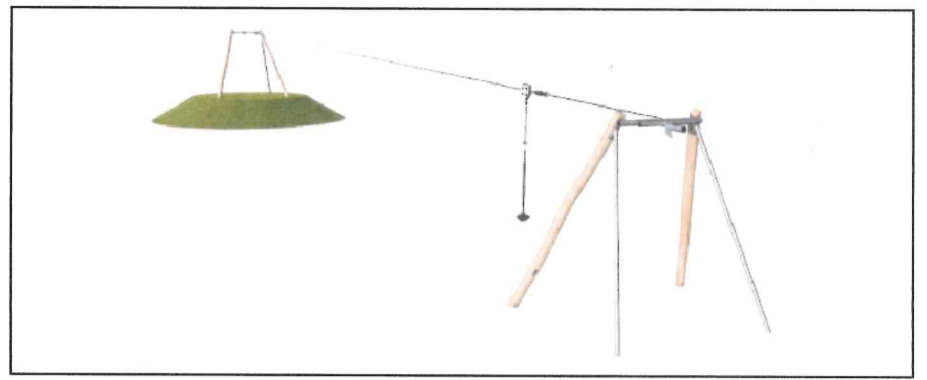

02 TYPICAL CABLEWAY IMAGE [OR SIMILAR APPROVED / EQUIVALENT CABLEWAY]



TYPICAL EQUIPMENT	
01	Multi Use Games Area [MUGA] - REFER TO SPECIFICATION SHEET 01 A
02	Cableway - REFER TO SPECIFICATION SHEET 01 B

LEGEND

PROPOSED SITE OUTLINED IN RED	
AREA FOR PROPOSED MUGA	
AREA FOR PROPOSED CABLEWAY	
EXISTING PLAYGROUND SITE	

Project Name:	Proposed Multi Use Games Area [Muga] + Cableway at Carrowteige Ballina Co Mayo		
Drawing Title:	Proposed Site Layout Plan [Schematic / Specimen Layout]		
Drawing Status:	Tender		
Dwg By:	DC	Date: March 2020	Dwg No: 02 - B
		Scale: 1: 400	
Ck By:	PG	Sheet size: A3	Revision No: 0

PROPOSED SITE LAYOUT PLAN
SCALE 1: 400 @ A3

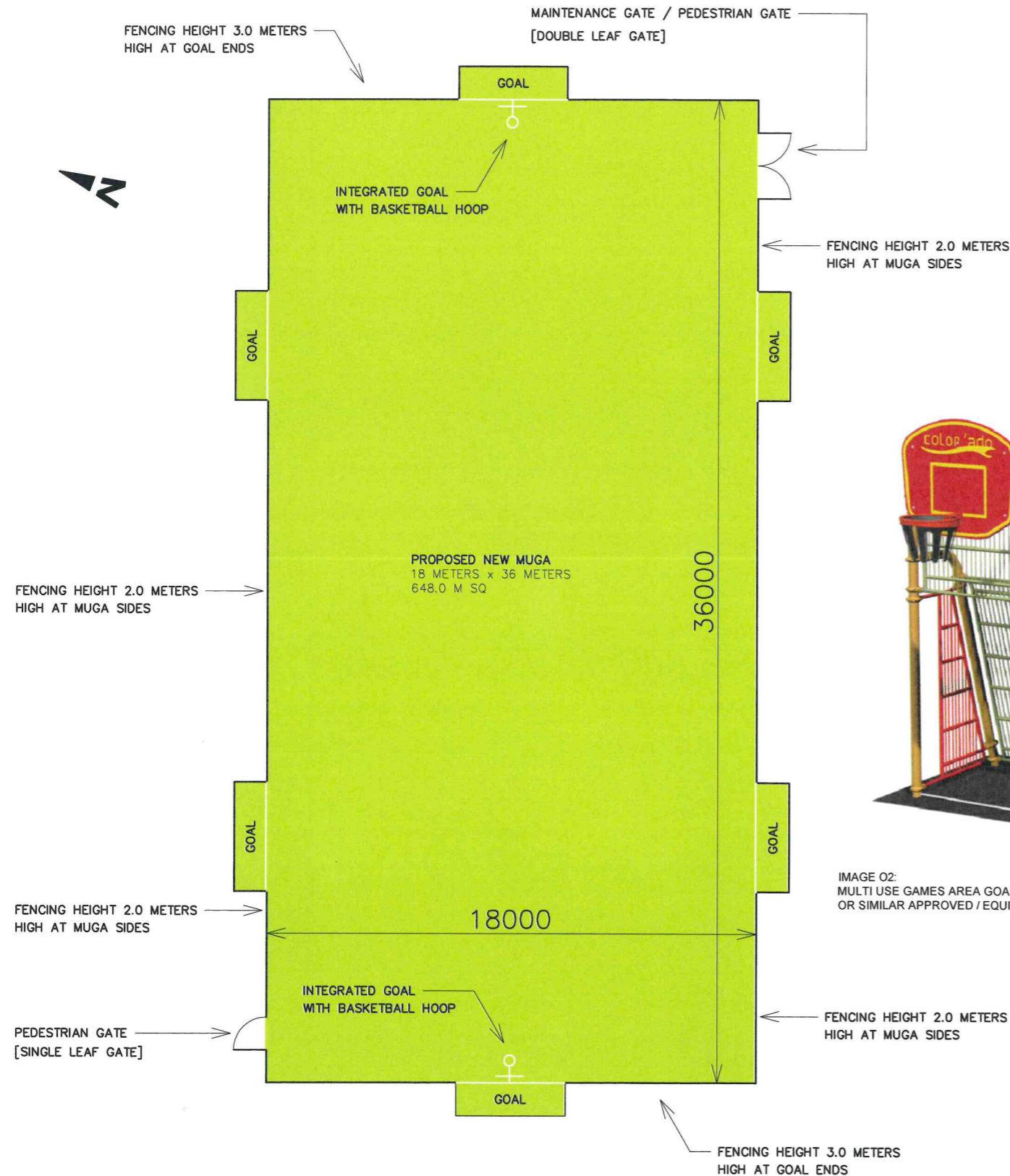

IMAGE 01:
MULTI USE GAMES AREA; GOAL WITH INTEGRATED BASKETBALL HOOP OR SIMILAR APPROVED / EQUIVALENT FACILITY



IMAGE 03:
SYNTHETIC GRASS
OR SIMILAR APPROVED / EQUIVALENT SURFACING + LINE MARKING



IMAGE 04:
PANEL EXTREMELY RIGID WITH STEEL FRAME AND 10MM BARS
OR SIMILAR APPROVED / EQUIVALENT ASSEMBLY UNIT



IMAGE 02:
MULTI USE GAMES AREA GOAL WITH INTEGRATED BASKETBALL HOOP
OR SIMILAR APPROVED / EQUIVALENT UNIT



IMAGE 05:
SPECIAL VANDAL FIXINGS WITH STAINLESS BOLTING
OR SIMILAR APPROVED / EQUIVALENT ASSEMBLY



IMAGE 06:
NEW MULTIDIRECTIONAL ASSEMBLY BRACKETS
OR SIMILAR APPROVED / EQUIVALENT ASSEMBLY

Project Name:		Proposed Multi Use Games Area [Muga] at Carrowteige Ballina Co Mayo	
Drawing Title:		MUGA Layout Plan	
Drawing Status:		Tender	
Dwg By: DC	Date: March 2020	Dwg No: 02 - C	
Ck By: PG	Scale: 1: 200	Revision No: 0	
	Sheet size: A3		

02 - D PROPOSED MUGA + CABLEWAY AT CARROWTEIGE BALLINA CO MAYO

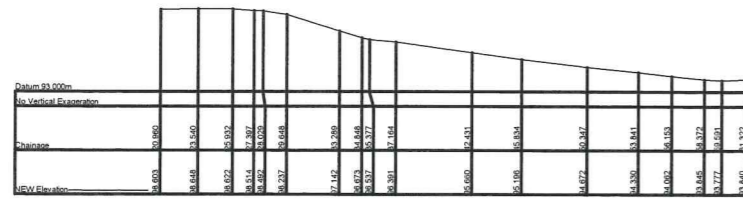

SECTION A-A
1:250

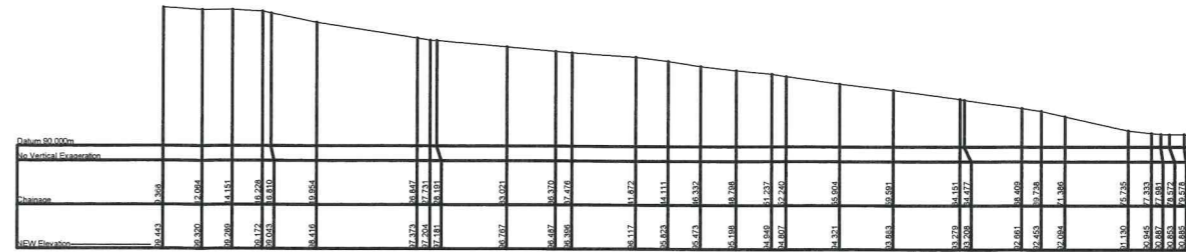

SECTION B-B
1:250

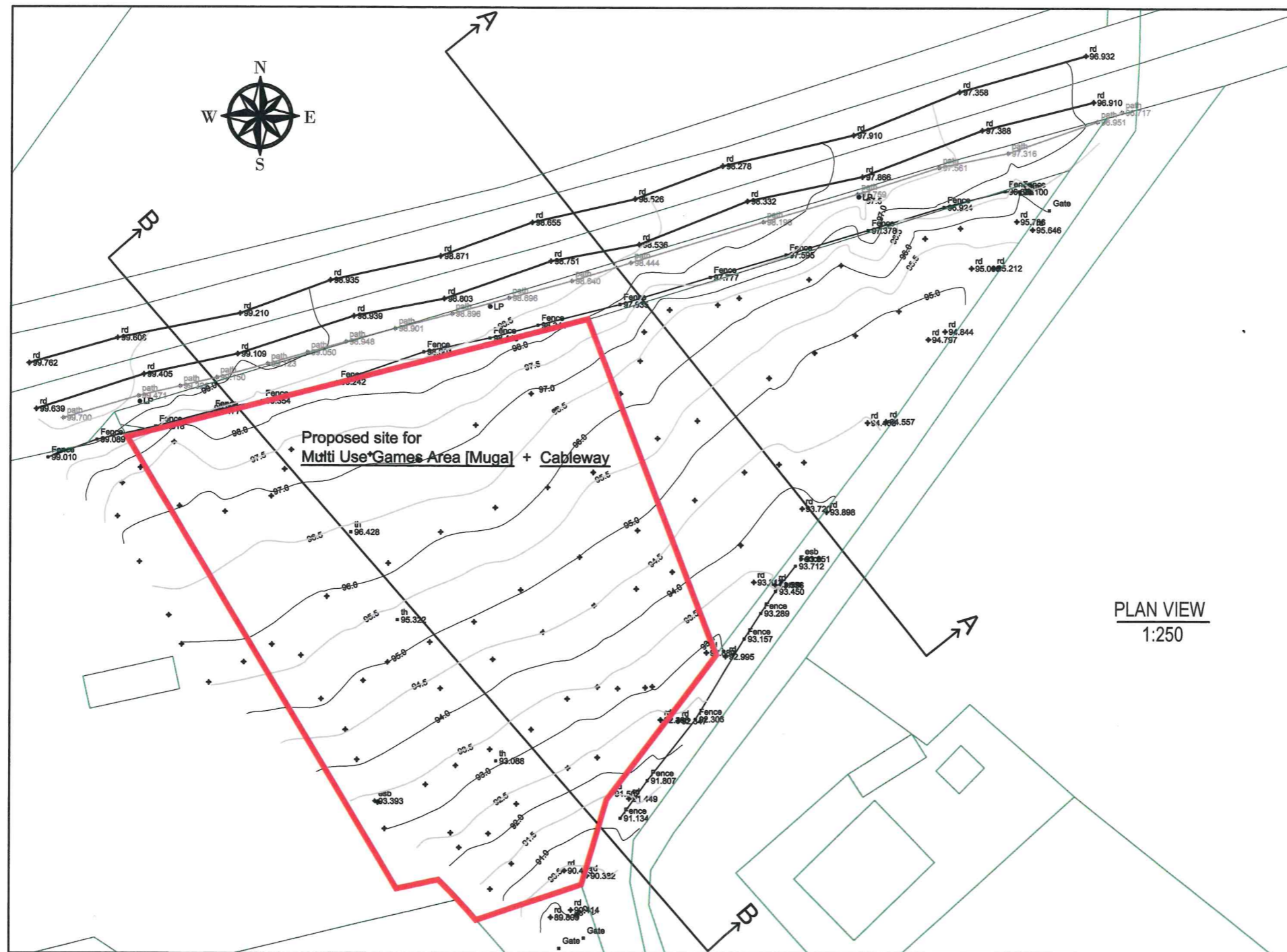

LEGEND

SITE OUTLINED IN RED



Project Name:		Proposed Multi Use Games Area [Muga] + Cableway at Carrowteige Ballina Co Mayo	
Drawing Title:		Site Survey + Geotechnical Design	
Drawing Status:		Tender	
Dwg By:	DC	Date:	March 2020
Dwg No:	02 - C	Scale:	1:250
Ck By:	PG	Sheet size:	A1
Revision No:	0		

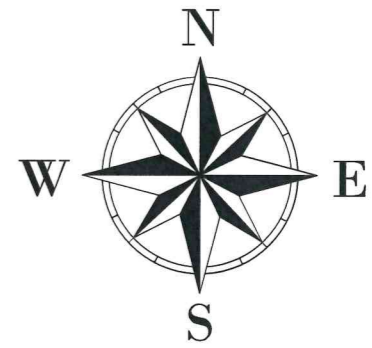
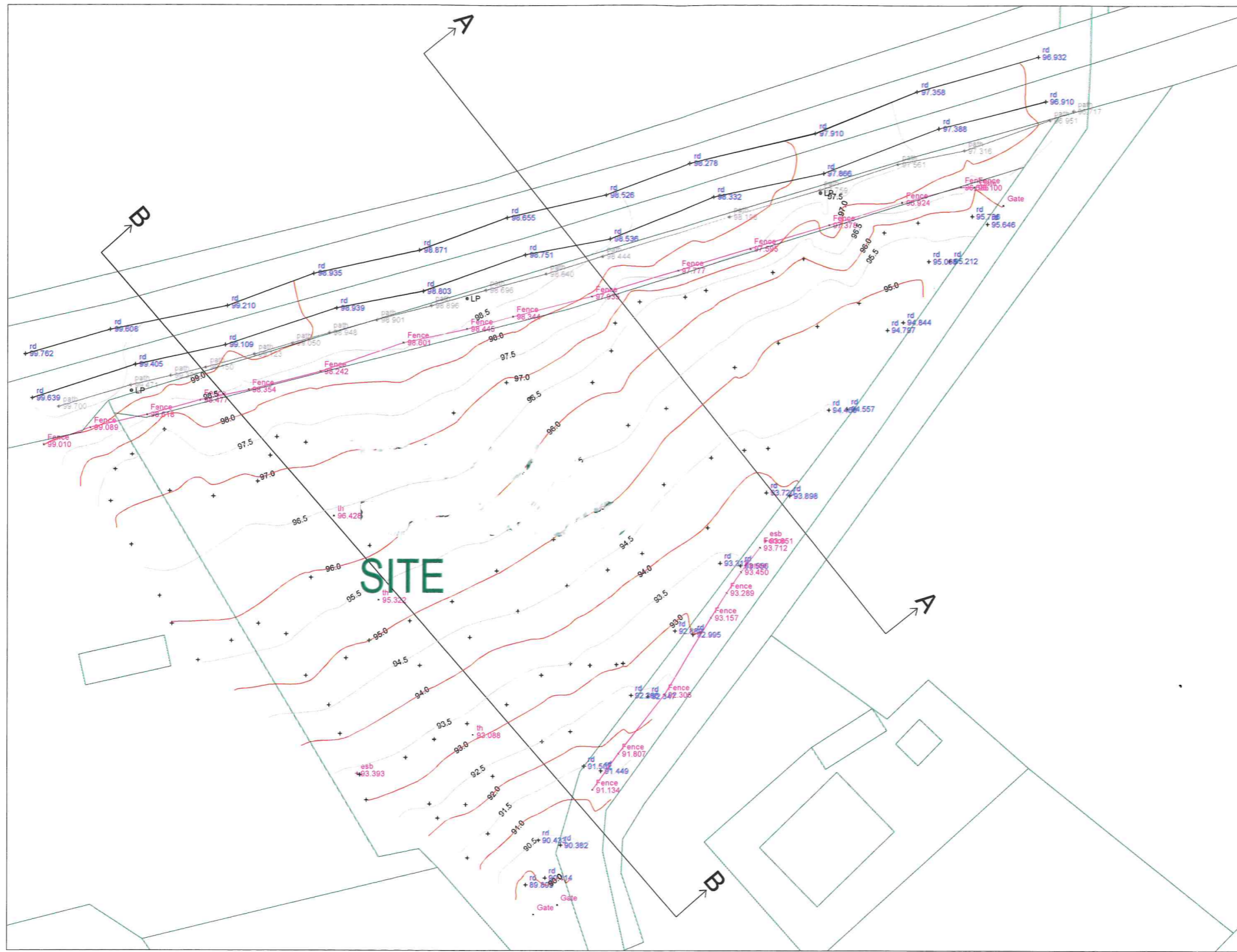

PLAN VIEW
1:250



SECTION A-A
1:250

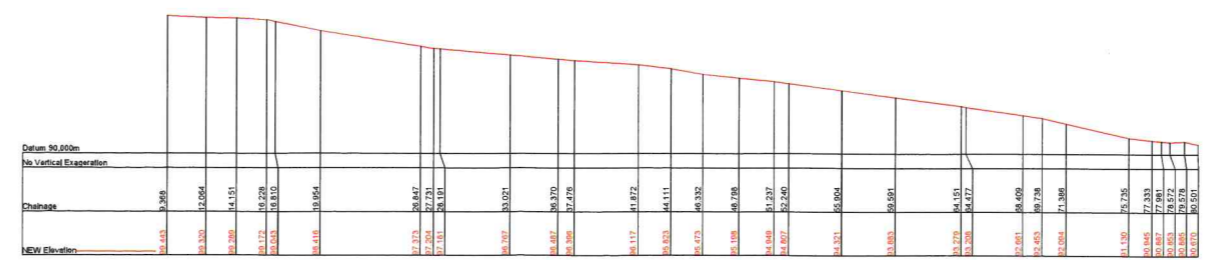

SECTION B-B
1:250

rev	date	revision	by
AS SHOWN@A3	24/10/17		

client:	CARROWTEIGE PLAYGROUND CO.MAYO	sheet no:	01
drawing title:	SITE SURVEY AND SECTIONS	drawing no:	17-161 DWG-01

scale:	AS SHOWN@A3
date:	24/10/17
disk ref no:	01
prepared by:	TG
chkd by:	DML
appd by:	DML

Údarús Business Park, Tourmakeady, Co.Mayo	Phone 094 9010130 Fax 094 9024137
--	--------------------------------------

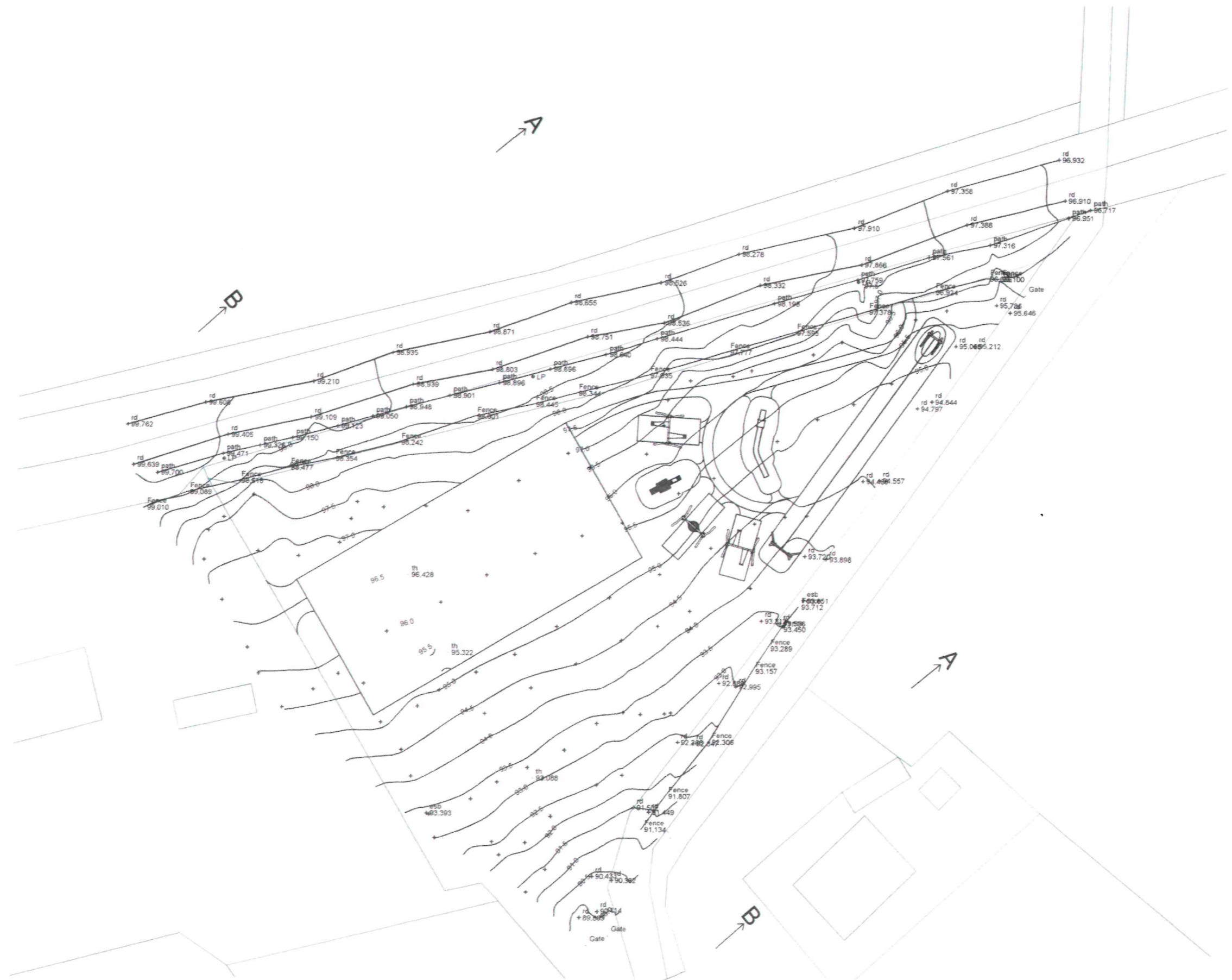



PLAN VIEW
1:500

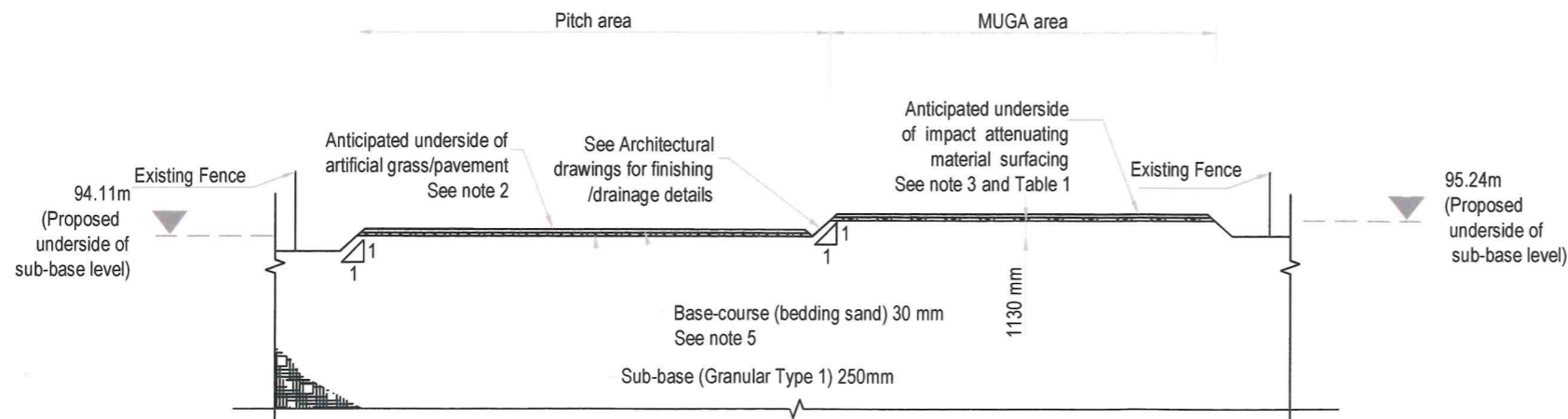

SECTION A-A
1:500

NOTES:

- 1 - Design i.a.w BS EN 1176-1:2017 & TII DN-PAV-03026
- 2 - The construction thicknesses suggested are based on CBR>2% of the sub-grade. Contractor should confirm this value by obtaining an appropriate number of test samples. Any discrepancy in CBR values should be reported to designer for more consideration. No problematic soil (e.g. Marl or peat) is assumed to remain after excavation.
- 3 - Table 1 provides options for impact attenuation materials considering the free heights of fall in playground. Note that the final specification may vary depending on the provider's particular pavement system.
- 4 - The illustrated slopes are guidelines for construction stages. For a permanent lifespan of playground, all exposed slopes should be stabilised according to architectural details and appropriate geotechnical design considering long-term condition of the ground including erosion, flooding, freezing and long-term drainage.
- 5 - The final course for artificial grass/ pavement should be according to architectural details and drawings. Note that the final specification may vary depending on the provider's particular pavement system.
- 6 - All levels are in m, and other dimensions are in mm.

Table 1- Minimum Depth of impact attenuating materials corresponding to the maximum free heights of fall

Maximum free heights of fall	Material	Minimum depth (mm)	Particle size (mm)
<2000	Bark	200	20-80
	Woodchip	200	5-30
	Sand or gravel	200	0.25 to 8 grain size
<3000	Bark	300	20-80
	Woodchip	300	5-30
	Sand or gravel ^a	300	0.25 to 8 grain size

^a Sand and gravel shall be well rounded and washed to eliminate most of the silt or clay particles.

Issued for comment

rev	date	revision	by
scale:	AS SHOWN@A3	client:	CARROWTEIGE PLAYGROUND CO. MAYO
date:	13/03/18	sheet no:	1 OF 2
disk ref no:	01	drawing title:	EXCAVATION AND BACKFILL WORKS
prepared by:	EM	drawing no:	17-161 DWG-02
chkd by:	DML	 Údarús Business Park, Tourmakeady, Co. Mayo Phone 094 9010130 Fax 094 9024137	
appd by:	DML		



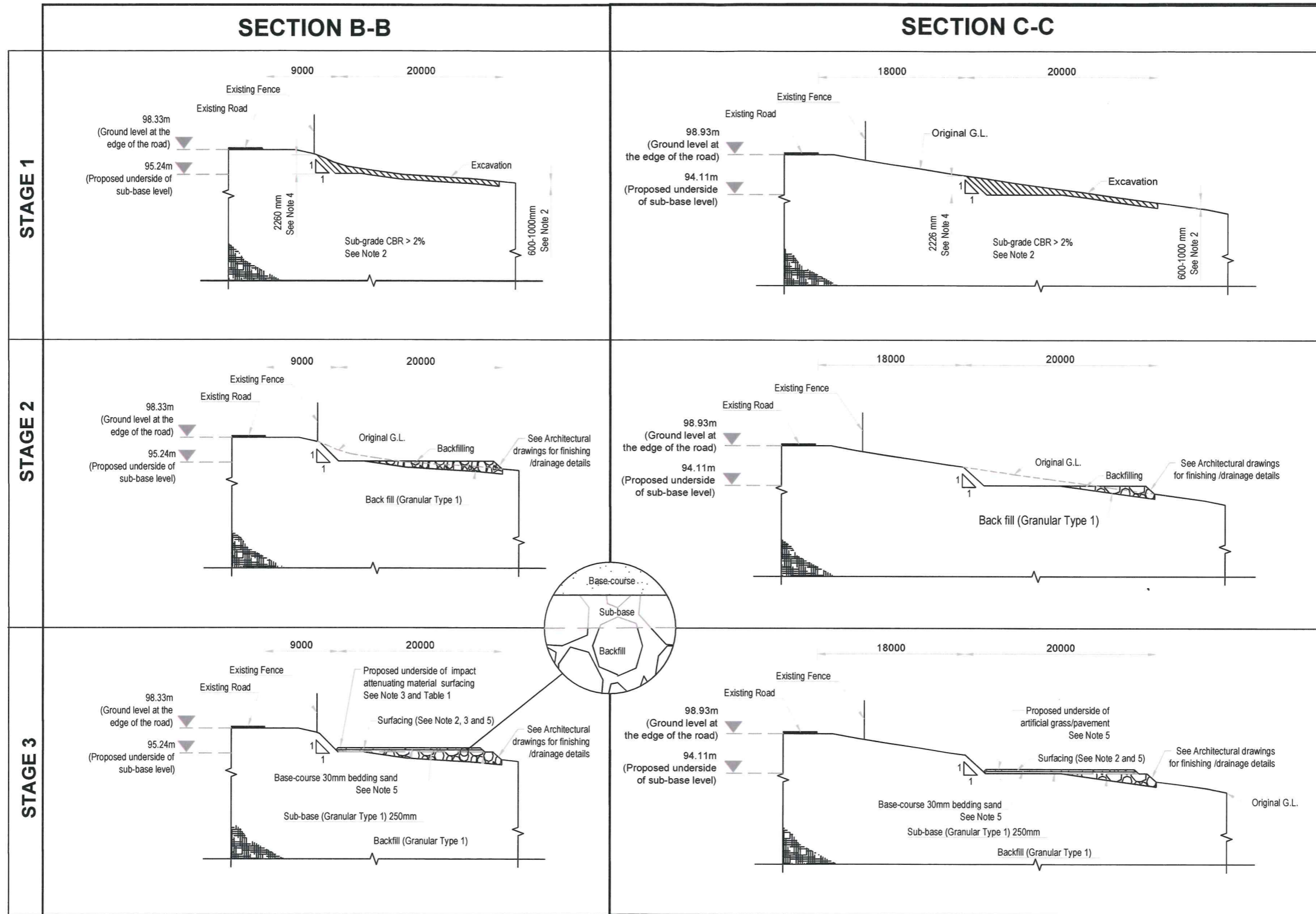

- LEGENDS:**
- Existing Ground
 - Excavation
 - Backfill
 - Sub-base
 - Base-course

Issued for comment

EXCAVATION AND BACKFILL SECTIONS
1:500

rev	date	revision	by
scale: AS SHOWN@A3 date: 13/03/18			
client: CARROWTEIGE PLAYGROUND CO. MAYO		sheet no: 2 OF 2	
disk ref no: 01 prepared by: EM chkd by: DML appd by: DML		drawing title: EXCAVATION AND BACKFILL WORKS drawing no: <div style="text-align: center;"> Údarús Business Park, Tournakeady, Co. Mayo Phone 094 9010130 Fax 094 9024137 </div>	
			17-161 DWG-02

02 - E PROPOSED MUGA + CABLEWAY AT CARROWTEIGE BALLINA CO MAYO



Project Name:	Proposed Multi Use Games Area [Muga] + Cableway at Carrowteige Ballina Co Mayo		
Drawing Title:	Site Photos		
Drawing Status:	Tender		
Dwg By:	DC	Date:	March 2020
		Scale:	NTS
Dwg No:	02 - E		
Ck By:	PG	Sheet size:	A3
		Revision No:	0