

NEWPORT REGENERATION PROJECT NO. 1
Proposed New Public Realm at Medicott Street, Newport Co Mayo

SCHEDULE OF PART 8 DOCUMENTATION

		Doc reference no.
	Public Notices	
1	Part 8 Site and Newspaper notice	
	Design Drawings;	
2	• Site Survey	F212-SUR1
	Civil Engineers Drawings;	
3	• Site Location Plan	21166-3000-P5
4	• Site Plan	21166-3020-P17
	Landscape Architects Drawings	
5	• Landscaping Plan	212-01-01
	Reports	
6	• Design report and Architectural Impact Assessment	
7	• Landscape Design	212-03-01
8	• Environmental Impact Assessment Screening Report	
9	• Appropriate Assessment and Determination	P7589

REV	DATE	BY	DESCRIPTION
P5	04.11.2021	TYL	ISSUED FOR PLANNING

DRAWING NOTES:

1. This Drawing is to be read in conjunction with the relevant Specifications & other Architectural & Engineering Drawings. Engineers to be informed immediately of any discrepancies before work proceeds.
2. Do Not Scale from this Drawing; -Metric Figured Dimension only are to be used.
3. It is "The Contractors" responsibility to ensure that all works are carried out in accordance with the requirements of the current Building Regulations and all other statutory documents relevant to this project including the grant of planning permission, Fire Safety Certificate and Disability Access Certificate.
4. SDS (Structural Design Solutions) Ltd / SDS-UK (Structural Design Solutions) Ltd. bear no liability for unilateral changes/modifications made during the course of construction based on the drawing prepared, without prior consultation and confirmation of acceptance of the revision by SDS (Structural Design Solutions) Ltd. / SDS-UK (Structural Design Solutions) Ltd.

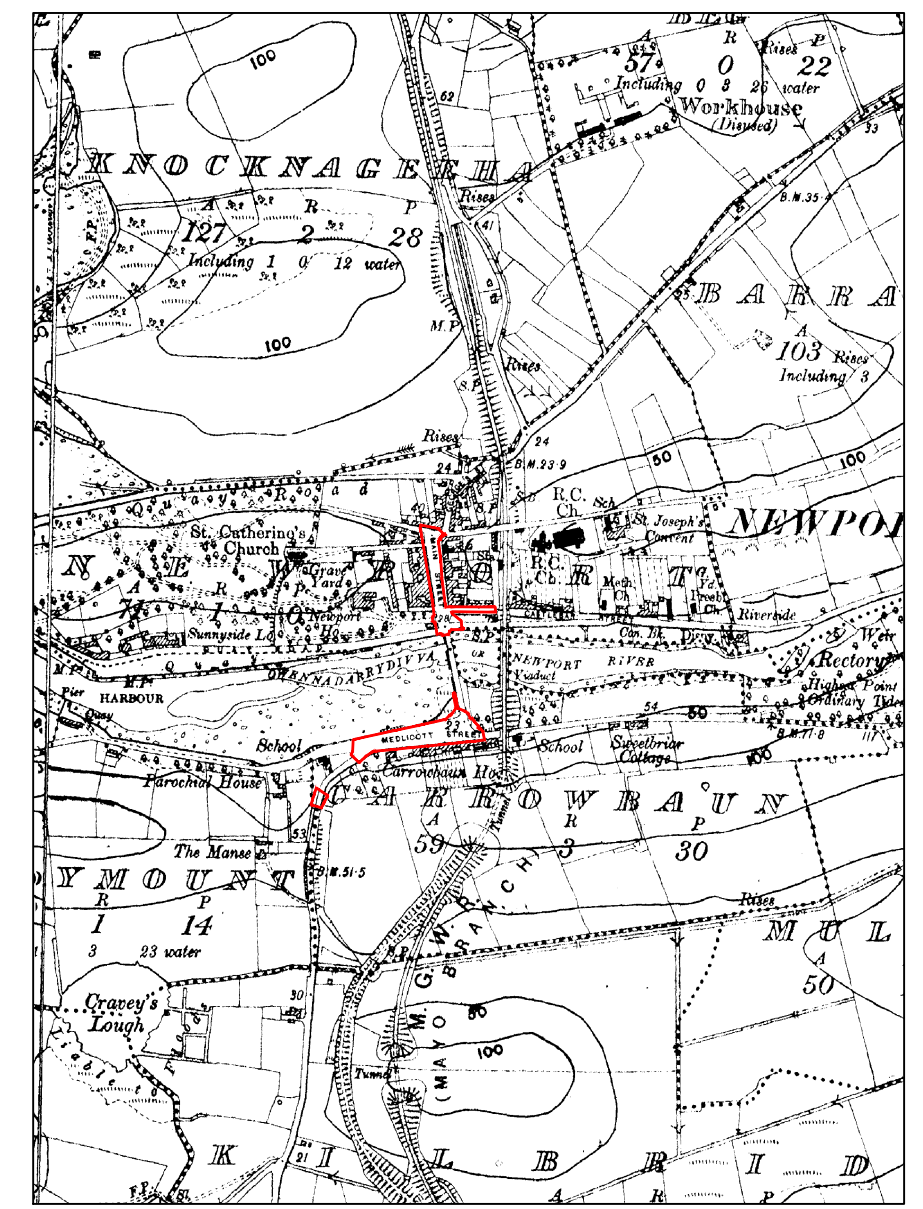
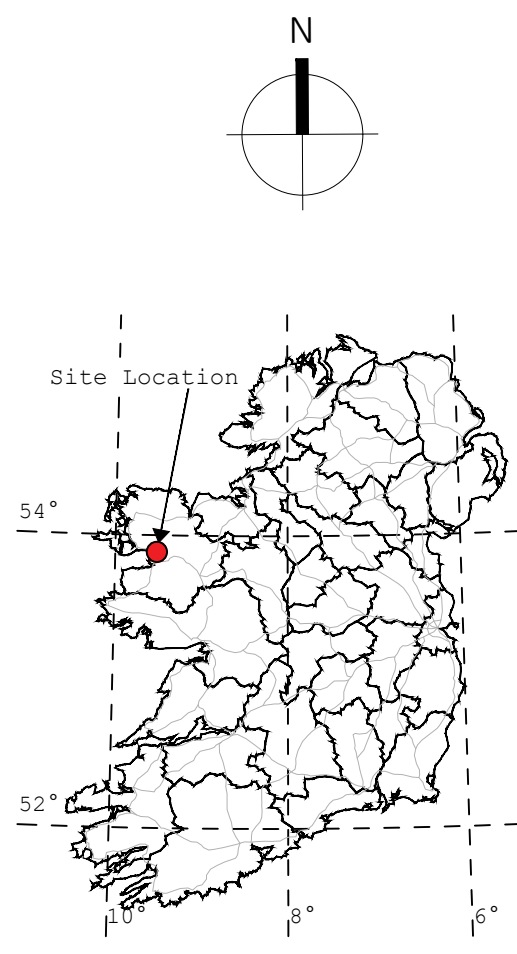
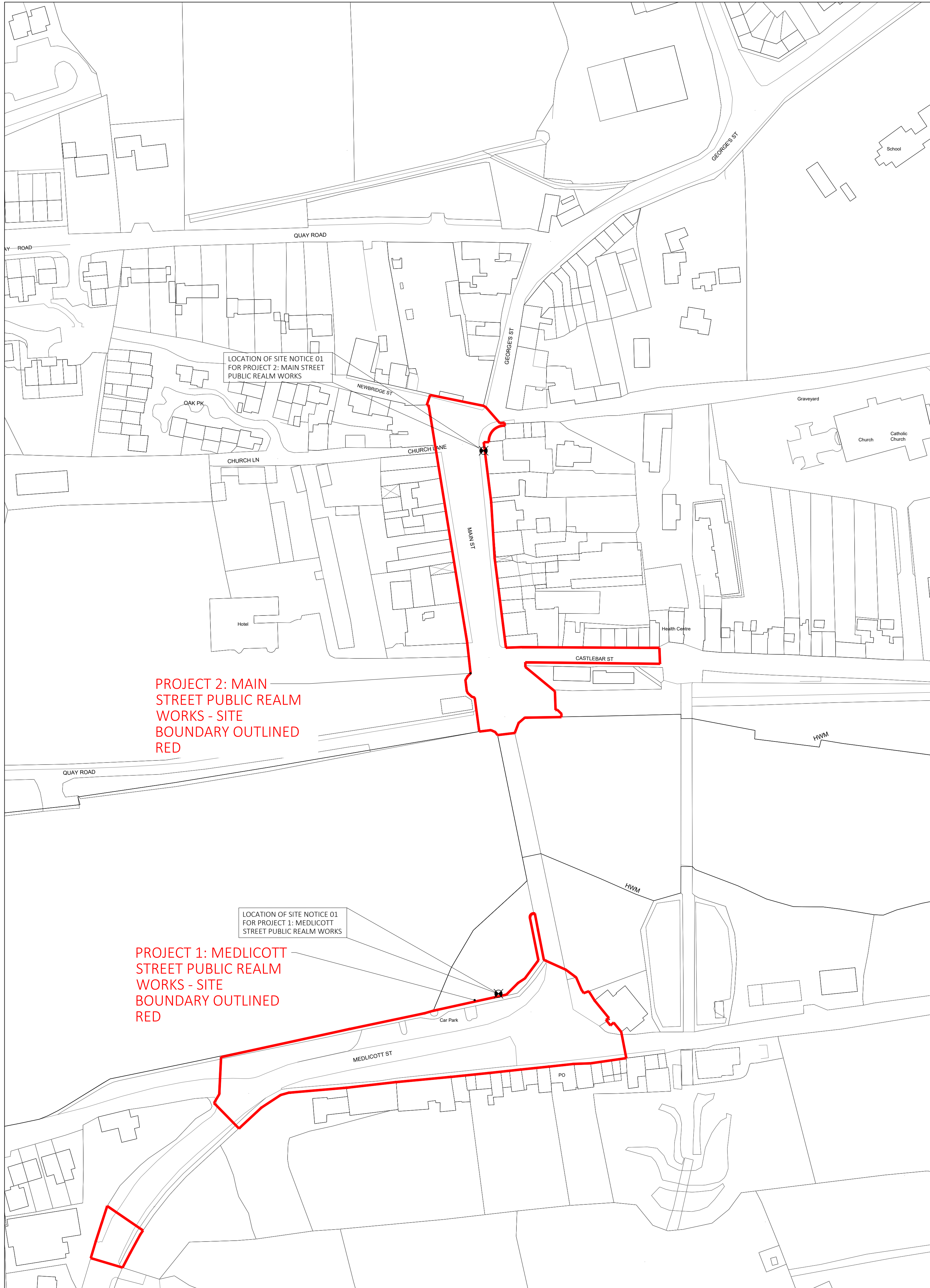

OSI SITE LOCATION MAP
1:10560

OSi Digital Map Information:

Description: Digital Cartographic Model (DCM)
 Output Format: Autodesk AutoCAD (DWG_R2013)
 Output File: v_50201506_1.dwg
 Data Source / Reference: PRIME2
 Map Series | Map Sheets: 1:2,500 | 1901-B
 Clip Extent: LIX.LLY= 498121.0,793649.5
 LIX.LRY= 498551.0,793649.5
 ULX.ULY= 498121.0,794232.5
 URX.URY= 498551.0,794232.5
 Projection: IRENET95_Irish_Transverse_Mercator
 ITM Centre Point Co-ordinate: X,Y= 498336.0,793941.0
 Extraction Date: 21-Jun-2021
 Copyright:
 © Ordnance Survey Ireland, 2021
 Compiled and published by Ordnance Survey Ireland, Phoenix Park, Dublin 8, Ireland.
 Unauthorised reproduction infringes Ordnance Survey Ireland and Government of Ireland copyright.
 All rights reserved. No part of this publication may be copied, reproduced or transmitted in any form or by any means without the prior written permission of the copyright owners.
 The representation on this map of a road, track or footpath is not evidence of the existence of a right of way.
 Ordnance Survey maps never show legal property boundaries, nor do they show ownership of physical features.

DRAWING LEGEND	
APPLICATION SITE BOUNDARY	

OSI SITE LOCATION MAP
SCALE 1:1,000

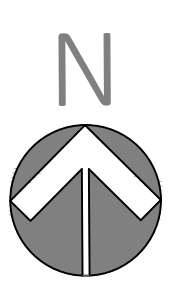

© THIS DRAWING IS PROTECTED BY COPYRIGHT AND IS THE PROPERTY OF SDS (Structural Design Solutions) Ltd. / SDS-UK Ltd. IT MAY NOT BE USED, REPRODUCED OR DISCLOSED TO ANYONE WITHOUT THE PRIOR WRITTEN APPROVAL OF THE AUTHORS.

SDS (Structural Design Solutions) Ltd.
 Head Office: Unit 9, NS Business Park, Castlebar, Co. Mayo. Tel: +353 (0)94 9034914
 Dublin: 46 Dawson Street, Dublin 2. Tel: +353 (0)1 6877480
 London: Bridge House, 25-27 The Bridge, Wealdstone, Harrow, HA3 5AB. Tel: +44 (0)20-30266724
 Middle East: Ibn Sena Street, P.O. Box 2514, Doha. Tel: +974 (0)33 731378
 info@structuraldesign.ie Web: www.structuraldesign.ie

MAYO COUNTY COUNCIL

Project Title: **PROPOSED NEWPORT REGENERATION PROJECT 1 & PROJECT 2**

Drawn Title: **OSI SITE LOCATION MAPS SHOWING THE APPLICATION SITE BOUNDARY**

Scale	AS SHOWN	Page Size	A1	Status	PLANNING
Drawn by	TAS	Date	OCT 2021	Checked	SG
Project No.	21166	Drawing No.	3000	Revision	P5

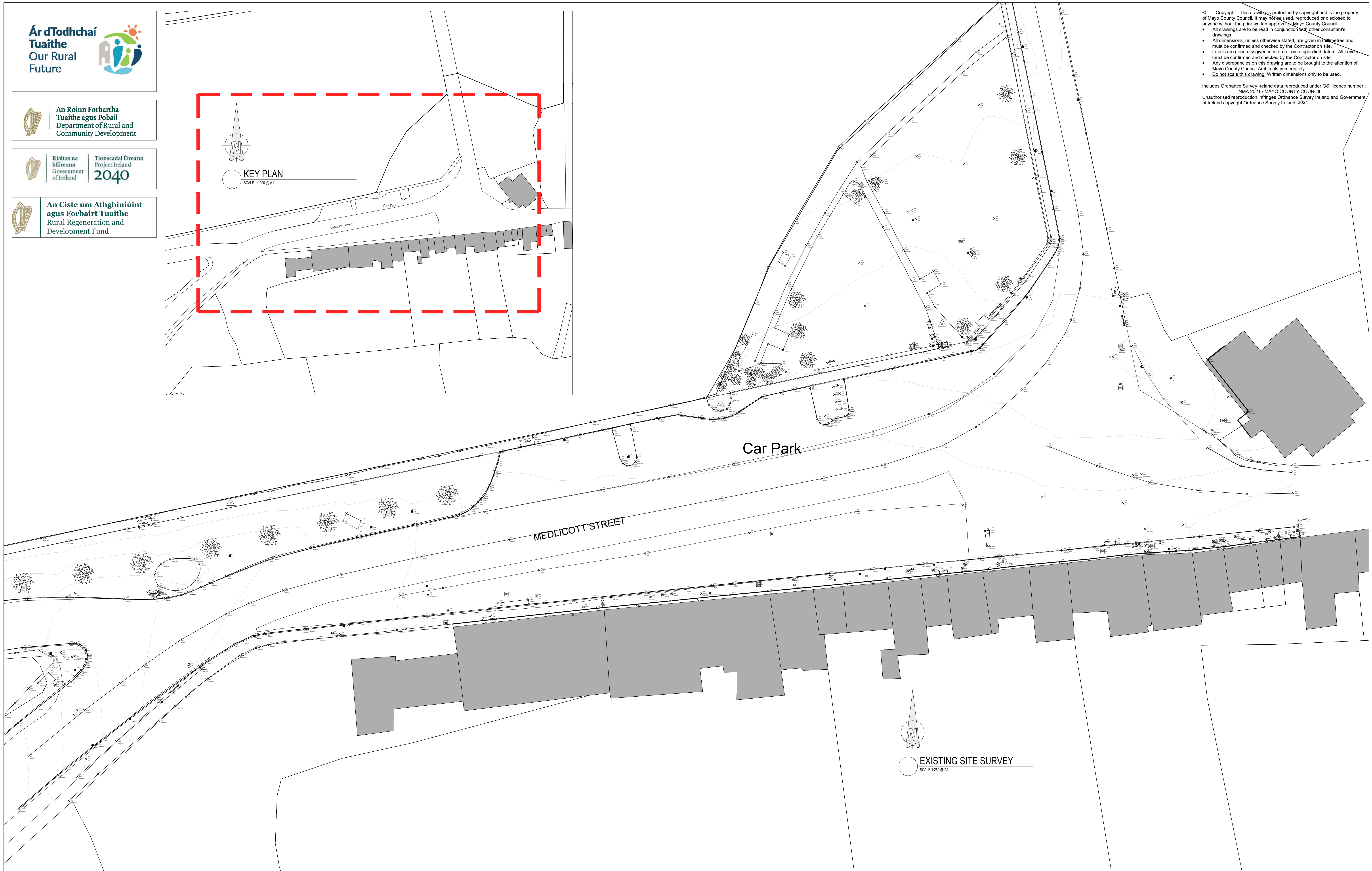
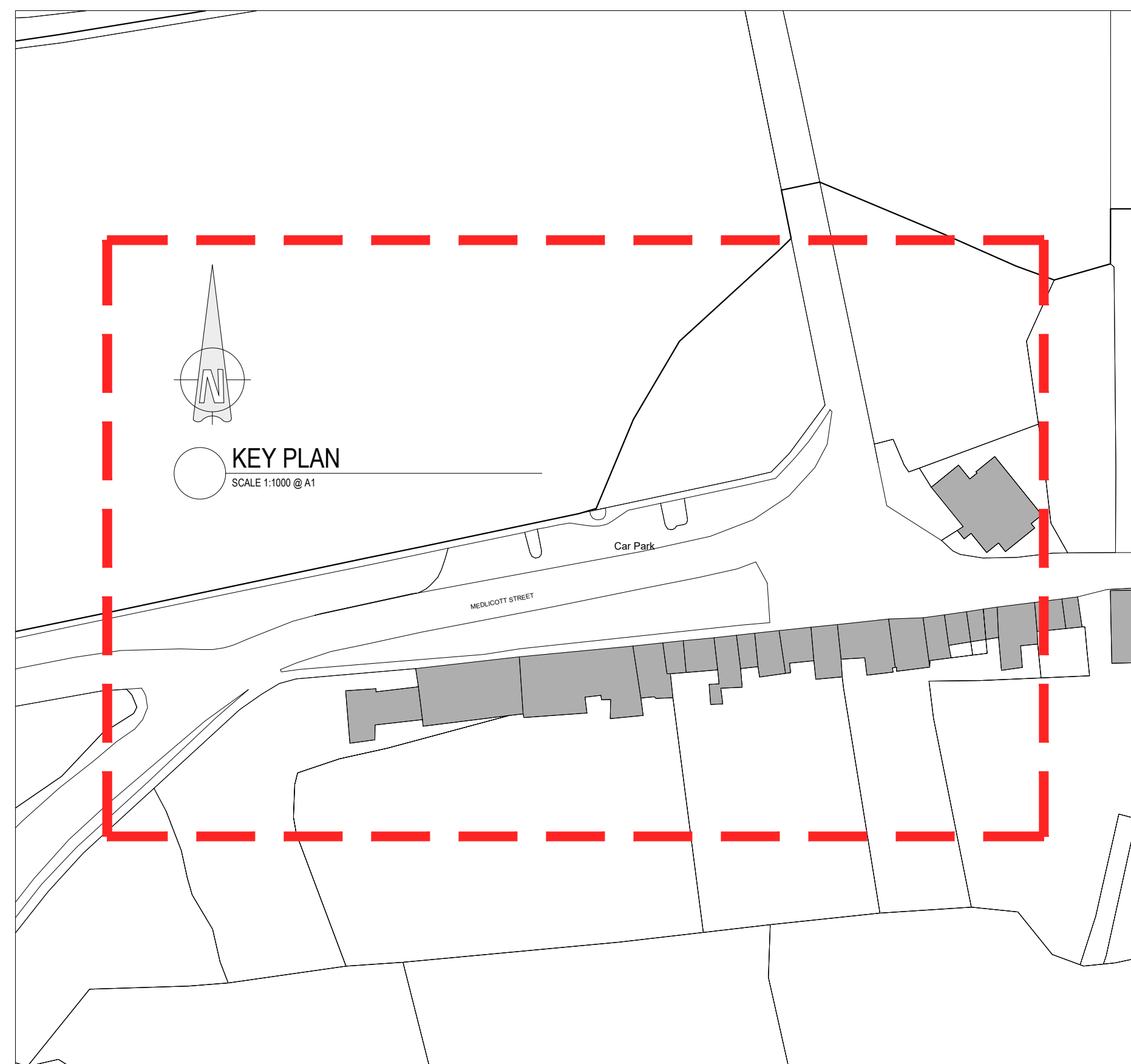

© Copyright - This drawing is protected by copyright and is the property of Mayo County Council. It may not be used, reproduced or disclosed to anyone without the prior written approval of Mayo County Council.
 • All drawings are to be read in conjunction with other consultant's drawings.
 • All dimensions, unless otherwise stated, are given in millimetres and must be confirmed and checked by the Contractor on site.
 • Levels are generally given in metres from a specified datum. All Levels must be confirmed and checked by the Contractor on site.
 • Any discrepancies on this drawing are to be brought to the attention of Mayo County Council Architects immediately.
 • Do not scale this drawing. Written dimensions only to be used.

Includes Ordnance Survey Ireland data reproduced under OSI licence number: NMA 2021 / MAYO COUNTY COUNCIL
 Unauthorised reproduction infringes Ordnance Survey Ireland and Government of Ireland copyright Ordnance Survey Ireland 2021

Status Key		Rev. No.	Date:	Comment
SHARED / FOR INFORMATION				
S0	WORK IN PROGRESS			
S1	COORDINATION INFORMATION			
S2	REVIEW / COMMENT			
S3	CONST. APPROVAL			
S4	COSTING			
D1	TENDER			
D2	CONTRACTOR DESIGN			
D3				
PUBLISHED				
A1	PTS / FSC / DAC			
A2	CONSTRUCTION			
AB	AS-BUILT			



ARCHITECTS DEPARTMENT
MAYO COUNTY COUNCIL



Project No:	F212	Project Title:	NEWPORT PUBLIC REALM WORKS	Dwg Type:	SURVEY	Status:	A1
Drawing Title:	EXISTING SITE SURVEY MEDLICOTT STREET			Drawing No.:	SUR-01	Revision:	/
Drawn By:	PM	Proj No - Orig - Cat - Lvl - Type - Role - No. - Status		Scale:	1:250	First Issue:	08/11/2021
Checked By:	NA	A-123 - MCC -	DesignA - - Design				



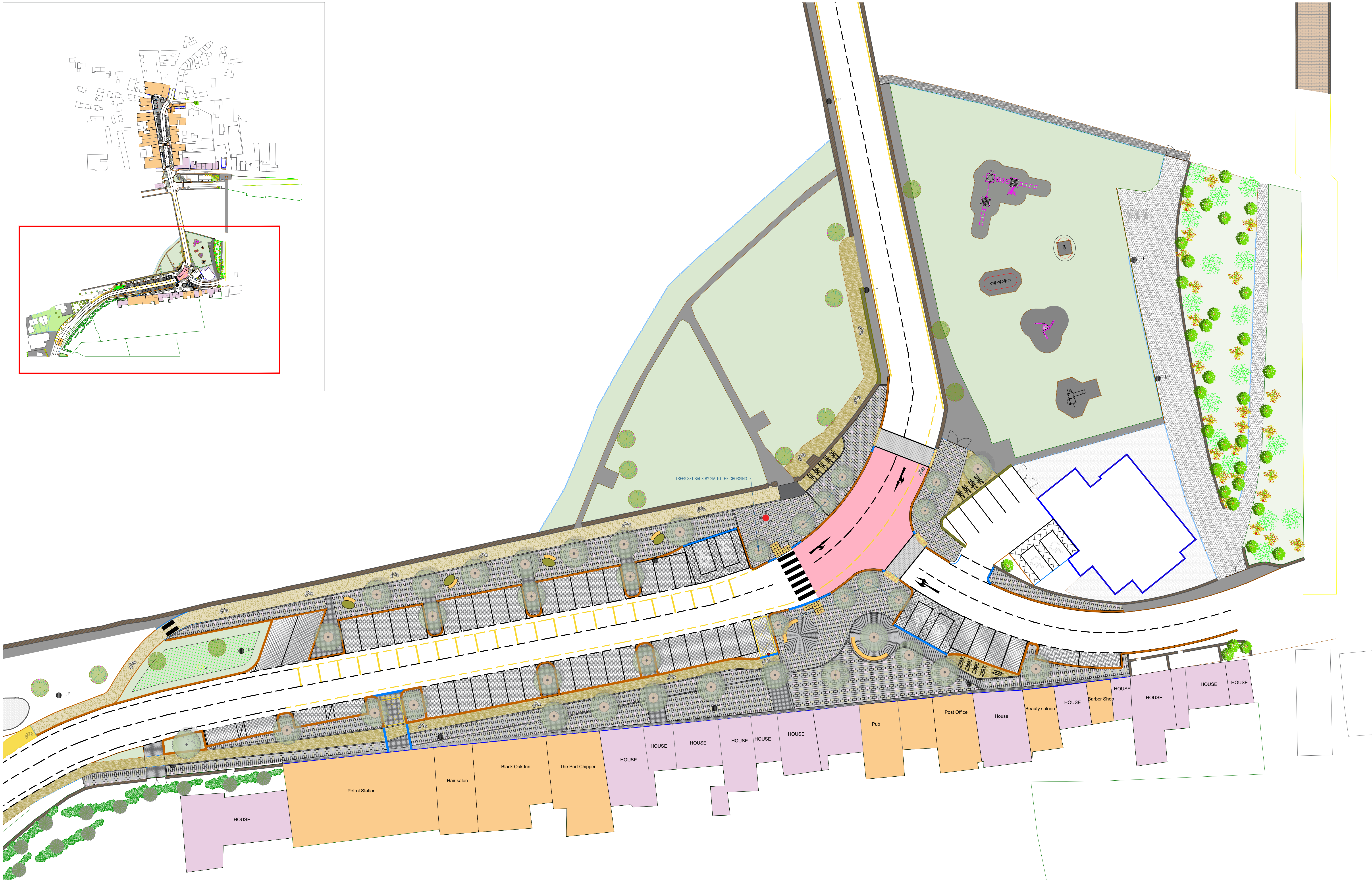

- Legend**
- Residential Building
 - Commercial Building
 - Paving Flag 600x300mm main pedestrian pathway
 - Paving Sets 150x150mm pattern detail
 - Black sets 150x150mm detail adjacent to building line
 - Block paving
 - Car Parking Bays
 - Crossing paving block
 - Resin
 - Proposed Limestone kerb to match existing
 - Proposed Limestone kerb laid flush to match existing
 - Bulb planting
 - Lawn
 - Mixed ornamental planting
 - Proposed tree
 - Curved seating
 - Tree Grille
 - Oval planters with seat
 - Planters
 - Bike Stand



An Roinn Forbartha Tuaithe agus Pobail
Department of Rural and Community Development



An Ciste um Athghiniúint agus Forbairt Tuaithe
Rural Regeneration and Development Fund



Rialtas na hÉireann
Government of Ireland



Tionscadal Éireann Project Ireland 2040



Ár dTodhchaí Tuaithe
Our Rural Future



JANE Mc CORKELL
Landscape Architect



Registered Landscape Architect

The drawing is the copyright of Jane McCorkell Landscape & Garden Design. It has been produced for the client and project as stated above. The drawing may not be reproduced or amended, used for the written permission of Jane McCorkell Landscape & Garden Design. No liability will be accepted for any amendments made by other persons.

Project: NEWPORT REGENERATION PROJECT - MEDICOTT STREET	Client: MAYO COUNTY COUNCIL	Scale: 1:250	Date: 11/05/2019
Drawn by: JMC	Checked by: JMC	Drawn on: 05/04/2019	Drawn at: 11/05/2019
Rev: 01	Rev: 01	Rev: 01	Rev: 01

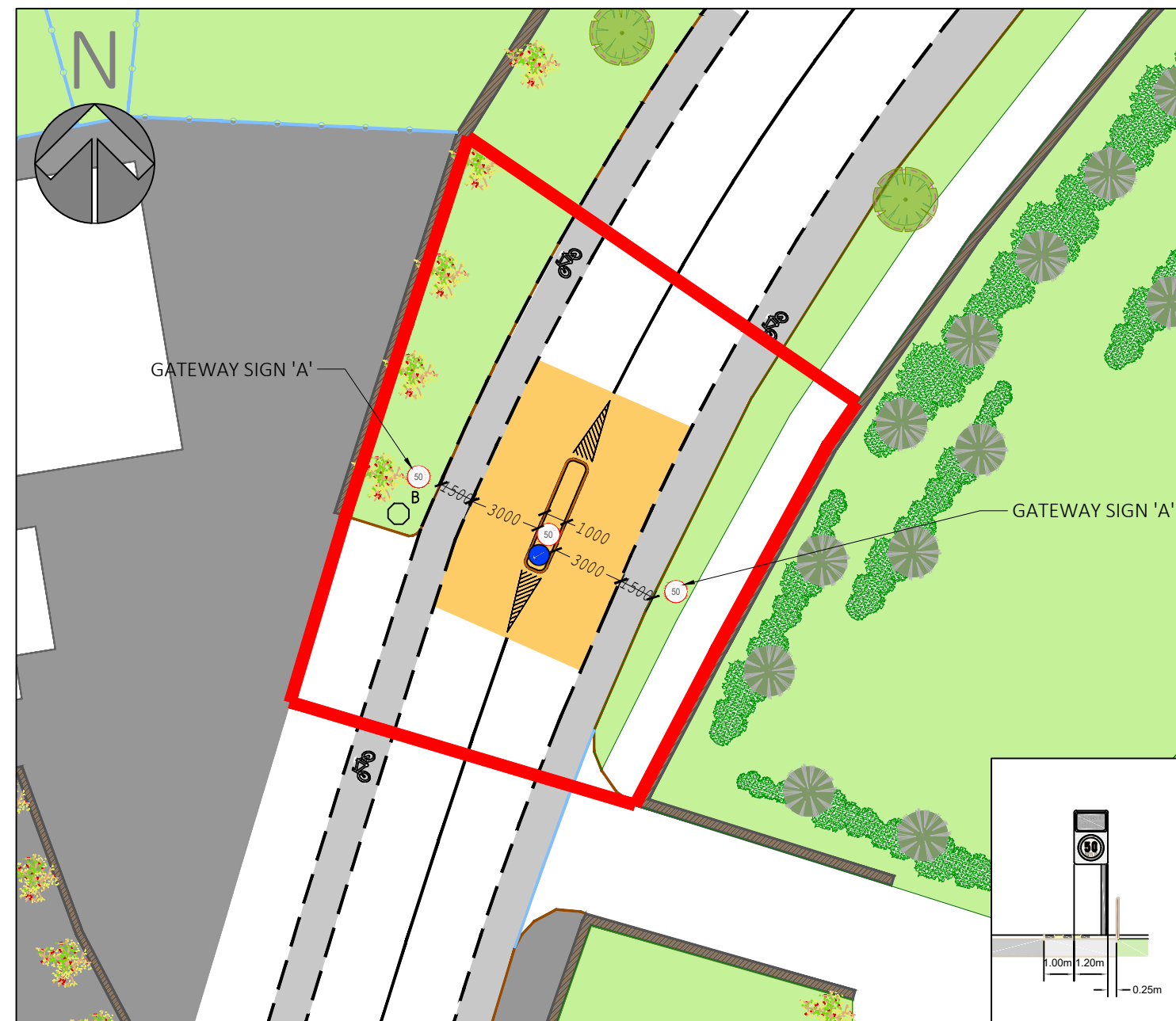

PROPOSED SITE LAYOUT PLAN - MEDLICOTT STREET - VIEW 1

SCALE = 1:250

GATEWAY SIGN - SAMPLE

SCALE = 1:200

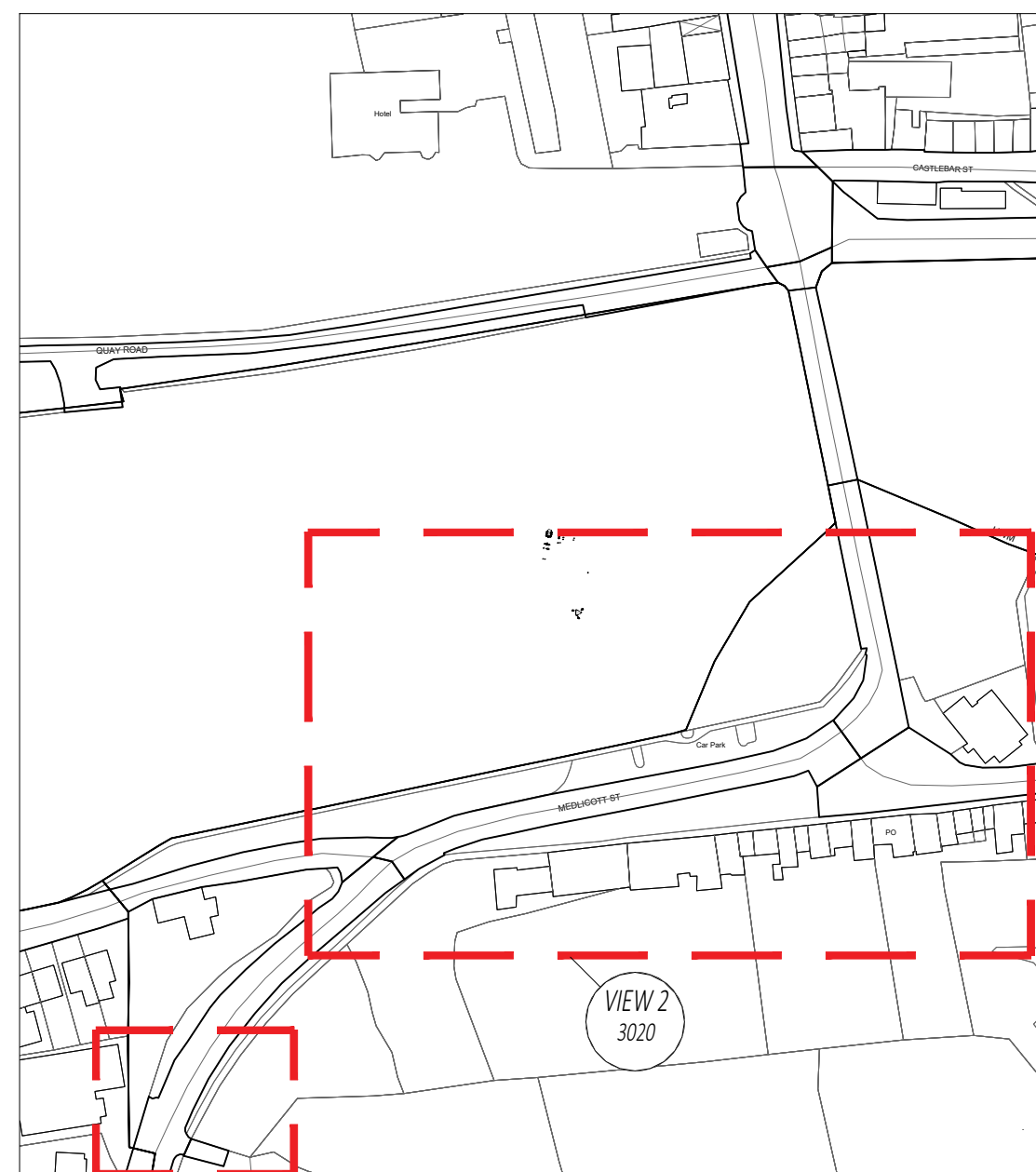

KEY PLAN

SCALE = 1:2000

VIEW 1

3020

VIEW 2

3020

LOCATION OF SITE NOTICE 01 FOR PROJECT 1 - MEDLICOTT STREET PUBLIC REALM WORKS



PROPOSED SITE LAYOUT PLAN - MEDLICOTT STREET - VIEW 2

SCALE = 1:250



Rialtas na hEireann
Government of Ireland

Tionscadal Eireann
Project Ireland
2040



An Roinn Forbartha
Tuaithe agus Pobail
Department of Rural and
Community Development



An Ciste um Athghiniúint
agus Forbairt Tuaithe
Rural Regeneration and
Development Fund

© THIS DRAWING IS PROTECTED BY COPYRIGHT AND IS THE PROPERTY OF SDS (Structural Design Solutions) Ltd. / SDS-UK Ltd. IT MAY NOT BE USED, REPRODUCED OR DISCLOSED TO ANYONE WITHOUT THE PRIOR WRITTEN APPROVAL OF THE AUTHORS.

SDS (Structural Design Solutions) Ltd,
Head Office: Unit 9, NS Business Park, Castlebar, Co. Mayo. Tel: +353 (0)94 9034914
Dublin: 46 Dawson Street, Dublin 2. Tel: +353 (0)1 6877480
London: Bridge House, 25-27 The Bridge, Woolstone, Harrow, HA3 5AB. Tel: +44 (0)20 30266724
Middle East: Ibn Sena Street, P.O. Box 2514, Doha. Tel: +974 (0)33 731378
✉ info@structuraldesign.ie Web: www.structuraldesign.ie



DRAWING NOTES:

- This Drawing is to be read in conjunction with the relevant Specifications & other Architectural & Engineering Drawings. Engineers to be informed immediately of any discrepancies before work proceeds.
- Do Not Scale from this Drawing. -Metric Figured Dimension only are to be used.
- It is "The Contractors" responsibility to ensure that all works are carried out in accordance with the requirements of the current Building Regulations and all other statutory documents relevant to this project including the grant of planning permission, Fire Safety Certificate and Disability Access Certificate.
- SDS (Structural Design Solutions) Ltd / SDS-UK (Structural Design Solutions) Ltd, bear no liability for unilateral changes/modifications made during the course of construction based on the drawing prepared, without prior consultation and confirmation of acceptance of the revision by SDS (Structural Design Solutions) Ltd / SDS-UK (Structural Design Solutions) Ltd.

REV	DATE	BY	DESCRIPTION
P17	08.11.2021	TD	PAVED AREAS UPDATED
P16	01.11.2021	TYL	ISSUED FOR PLANNING

MAYO COUNTY COUNCIL



Project Title
PROJECT 1: MEDLICOTT STREET PUBLIC REALM WORKS

Drawing Title

PROPOSED SITE LAYOUT PLAN - PROJECT 01 - MEDLICOTT STREET

Scale	1:250	Paper Size	A1	Status	PLANNING
Drawn by	TAS	Date	JUN 2021	Checked	SG
Project No	21166	Drawing No	3020	Revision	P17