

SITE LOCATION MAP 1:1000

© COPYRIGHT: T. The drawing is protected by copyright and is the property of RIAI. No part of this drawing may be reproduced, stored in a retrieval system, or transmitted in any form or by any means, electronic, mechanical, photocopying, recording, or by any information storage and retrieval system, without the prior written approval of Mayo County Council.

Do not scale this drawing. Within dimensions only to be used.

Scales as stated are valid on the original drawing only. Within dimensions take precedence over plan dimensions. Any dimensional discrepancies or deviations to be brought to the attention of the architect for review and approval.

All vertical dimensions shall be taken from "bench mark" or other agreed level unless otherwise stated. In ground level, low points, inequalities in floor slabs which could effect foundation / installation of Mayo County Council Architects immediately.

Drawings are to be read in conjunction with other consultants drawings.

All dimensions, unless otherwise stated, are given in millimetres and must be confirmed and checked by the Contractor on site.

All levels must be confirmed and checked by the Contractor on site. Any discrepancies on this drawing are to be brought to the attention of Mayo County Council Architects immediately.

Includes Ordnance Survey Ireland data reproduced under OS Licence number: NMA 2021 / MAYO COUNTY COUNCIL
 Unpublished reproduction includes Ordnance Survey Ireland and Government of Ireland copyright Ordnance Survey Ireland.



ORDNANCE SURVEY MAP NO.: Z738-B

ITM COORDINATES:
 514674E, 755459N

PROPOSED SITE BOUNDARIES OUTLINED IN RED
 0.092 ACRES / 0.033 Ha

● LOCATION OF SITE NOTICE

REVISIONS

No.	Date	Comments

DATE: 12/02/2024

SCALE: 1:1000

PROJECT: SITE LOCATION MAP

DRAWN BY: S2

CHECKED BY: S2

ARCHITECTS DEPARTMENT
 MAYO COUNTY COUNCIL



PROJECT: RESINING OF THE WATERS PUBLIC REALM
 PROJECT AT CONG, CO. MAYO
 SHEET: SITE LOCATION MAP

DATE: 12/02/2024

SCALE: 1:1000 @ A3



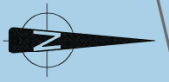

PROPOSED SITE BOUNDARIES
OUTLINED IN RED: 0.082 ACRES / (.033 Ha)

ORDNANCE SURVEY MAP NO.: 738-B

ITM COORDINATES: 514674E, 752459N

© copyright - This drawing is the property of Mayo County Council. It is not to be used for any other purpose without the prior written approval of Mayo County Council.
Do not scale this drawing. All dimensions are in millimetres unless otherwise stated.
Scales as stated are for reference only. Do not scale dimensions from the drawing. Best dimensions shall prevail over any other dimensions. The contractor shall verify all dimensions on site.
This drawing is intended to illustrate the general concept of the proposed development. It is not a contract document and does not constitute an offer of any kind. It is subject to the terms and conditions of the planning permission granted by Mayo County Council.
The contractor shall be responsible for obtaining all necessary permissions and approvals from the relevant authorities.
The contractor shall be responsible for ensuring that the proposed development complies with all applicable laws and regulations.
The contractor shall be responsible for ensuring that the proposed development is constructed in accordance with the approved plans and specifications.
The contractor shall be responsible for ensuring that the proposed development is completed within the agreed time frame.
The contractor shall be responsible for ensuring that the proposed development is maintained in accordance with the approved plans and specifications.
The contractor shall be responsible for ensuring that the proposed development is safe and secure for all users.
The contractor shall be responsible for ensuring that the proposed development is environmentally friendly and sustainable.
The contractor shall be responsible for ensuring that the proposed development is aesthetically pleasing and enhances the surrounding environment.
The contractor shall be responsible for ensuring that the proposed development is accessible to all people, including those with disabilities.
The contractor shall be responsible for ensuring that the proposed development is well-lit and secure at night.
The contractor shall be responsible for ensuring that the proposed development is well-ventilated and comfortable to use.
The contractor shall be responsible for ensuring that the proposed development is well-maintained and free from clutter.
The contractor shall be responsible for ensuring that the proposed development is well-organized and easy to navigate.
The contractor shall be responsible for ensuring that the proposed development is well-situated and convenient for all users.
The contractor shall be responsible for ensuring that the proposed development is well-located and easily accessible by public transport.
The contractor shall be responsible for ensuring that the proposed development is well-connected to the surrounding infrastructure.
The contractor shall be responsible for ensuring that the proposed development is well-served by essential services, such as water, electricity, and gas.
The contractor shall be responsible for ensuring that the proposed development is well-protected from fire and other risks.
The contractor shall be responsible for ensuring that the proposed development is well-secured and free from unauthorized access.
The contractor shall be responsible for ensuring that the proposed development is well-monitored and maintained on an ongoing basis.
The contractor shall be responsible for ensuring that the proposed development is well-managed and operated in accordance with the approved plans and specifications.
The contractor shall be responsible for ensuring that the proposed development is well-integrated into the surrounding community and environment.
The contractor shall be responsible for ensuring that the proposed development is well-received and appreciated by all stakeholders.
The contractor shall be responsible for ensuring that the proposed development is well-promoted and marketed to the target audience.
The contractor shall be responsible for ensuring that the proposed development is well-evaluated and reviewed on a regular basis.
The contractor shall be responsible for ensuring that the proposed development is well-improved and updated as needed.
The contractor shall be responsible for ensuring that the proposed development is well-communicated and transparent to all stakeholders.
The contractor shall be responsible for ensuring that the proposed development is well-governed and accountable to the public.
The contractor shall be responsible for ensuring that the proposed development is well-supported and funded by the relevant authorities.
The contractor shall be responsible for ensuring that the proposed development is well-protected and preserved for future generations.
The contractor shall be responsible for ensuring that the proposed development is well-used and enjoyed by all people.
The contractor shall be responsible for ensuring that the proposed development is well-loved and cherished by the community.
The contractor shall be responsible for ensuring that the proposed development is well-known and recognized by all people.
The contractor shall be responsible for ensuring that the proposed development is well-valued and respected by all people.
The contractor shall be responsible for ensuring that the proposed development is well-treasured and protected by all people.
The contractor shall be responsible for ensuring that the proposed development is well-remembered and honored by all people.
The contractor shall be responsible for ensuring that the proposed development is well-celebrated and commemorated by all people.
The contractor shall be responsible for ensuring that the proposed development is well-remembered and honored by all people.
The contractor shall be responsible for ensuring that the proposed development is well-celebrated and commemorated by all people.

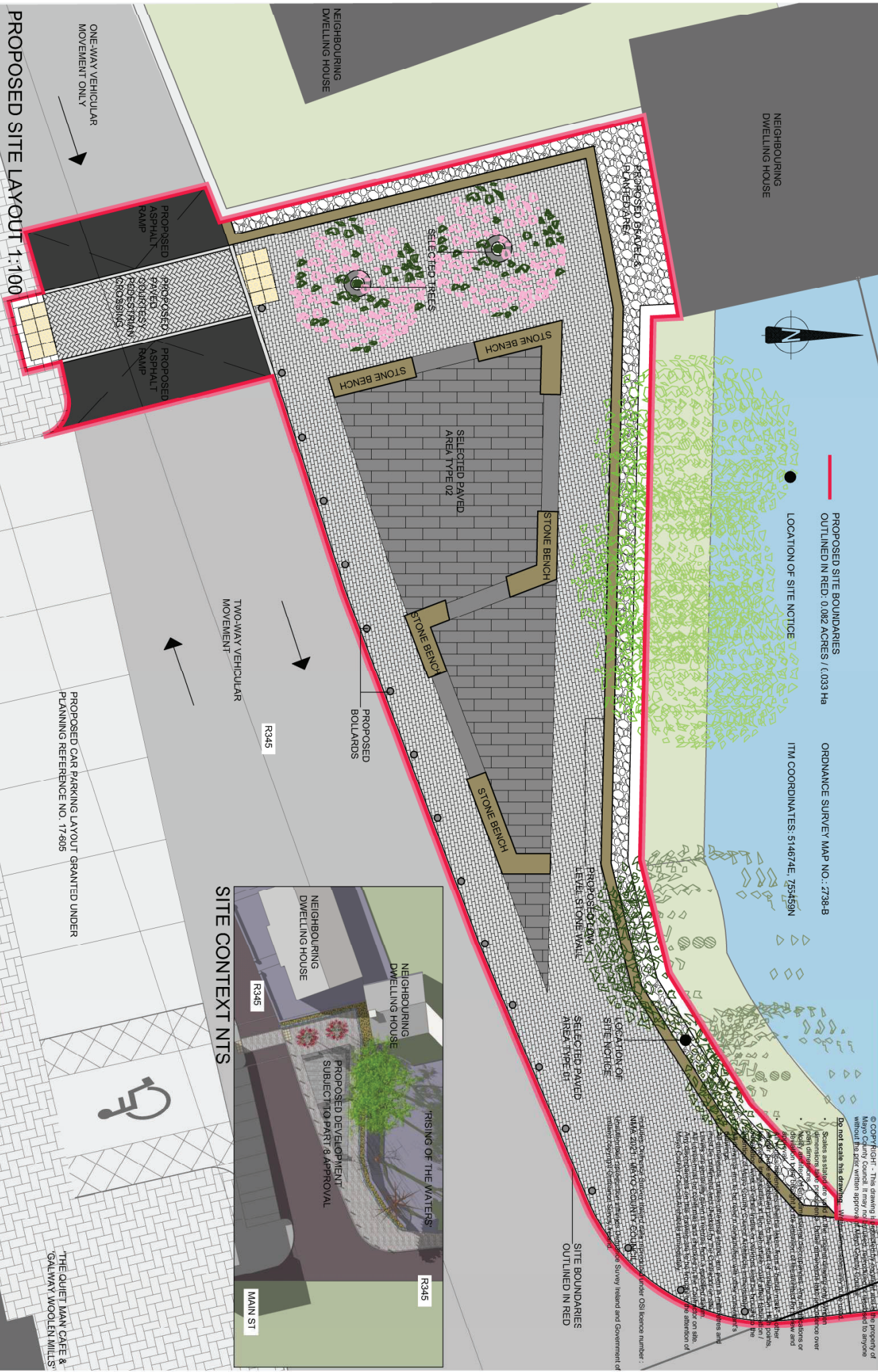

PROPOSED SITE LAYOUT 1:100

ONE-WAY VEHICULAR MOVEMENT ONLY

TWO-WAY VEHICULAR MOVEMENT

PROPOSED CAR PARKING LAYOUT GRANTED UNDER PLANNING REFERENCE NO. 17605

THE QUIET MAN CAFE & GALWAY WOOLLEN MILLS

REVISIONS	Rev. No.	Date	Comments
1			
2			
3			
4			
5			
6			
7			
8			
9			
10			
11			
12			
13			
14			
15			



ARCHITECTS DEPARTMENT
MAYO COUNTY COUNCIL



Project No.	ISSUES OF THE WATERS PUBLIC REALM
Client	PROJECT AT CONG. CO. MAYO
Drawing No.	PROPOSED SITE LAYOUT
Scale	1:100 @ A3
Date	12.02.2022
Drawn By	DC
Checked By	MS
Scale	1:100 @ A3
Date	12.02.2022



CSMD-I-CG003: 'RISING OF THE WATERS' CONG, CO. MAYO

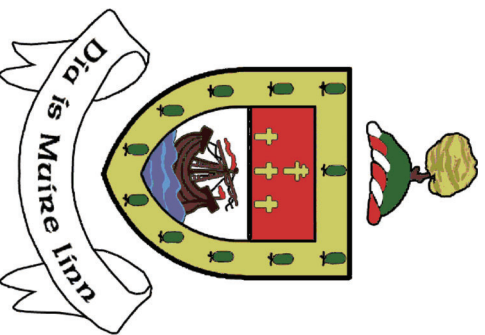

**CLAREMORRIS-SWINFORD
MUNICIPAL DISTRICT
MAYO COUNTY COUNCIL**

CLAREMORRIS AREA OFFICE,
KILCOLMAN ROAD, CLAREMORRIS,
CO. MAYO, F12 P383
TEL: 094-9064800



Do not scale this drawing. Written dimensions only to be used.

- Scales as stated are valid on the original drawing only. Written dimensions take precedence. Detail dimensions take precedence over plan dimensions.
- Notify architect of any dimensional discrepancies. Any modifications or deviation to be brought to the attention of the architect for review and approval.
- All vertical dimensions shall be taken from a "bench mark" or other similar guide established prior to the start of construction. High points, low points, Irregularities in floor slab which could affect fabrication / installation, work of other trades or vendors shall be brought to the attention of Mayo County Council Architects immediately.
- All drawings are to be read in conjunction with other consultant's drawings
- All dimensions, unless otherwise stated, are given in millimetres and must be confirmed and checked by the Contractor on site.
- Levels are generally given in metres from a specified datum.
- All Levels must be confirmed and checked by the Contractor on site.
- Any discrepancies on this drawing are to be brought to the attention of Mayo County Council Architects immediately.

Includes Ordnance Survey Ireland data reproduced under OS Licence number : NMA 2021 / MAYO COUNTY COUNCIL

Unauthorised reproduction infringes Ordnance Survey Ireland and Government of Ireland copyright Ordnance Survey Ireland.

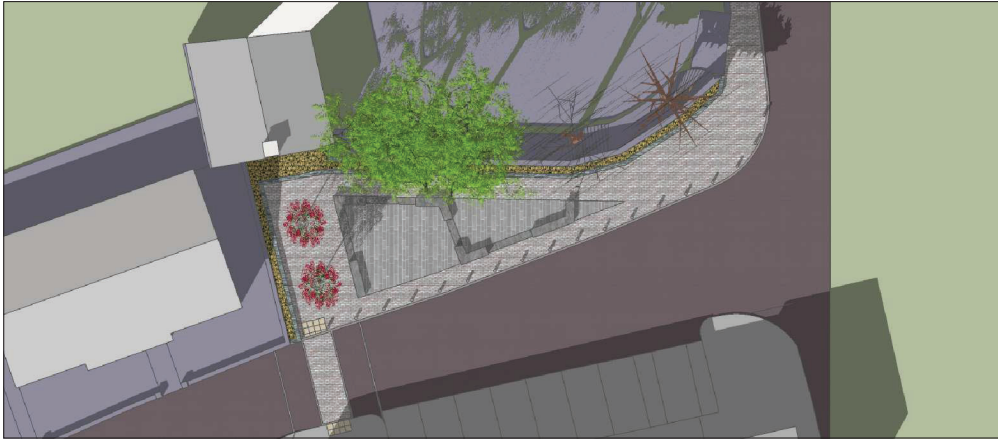

PROPOSED BIRDS EYE AERIAL VIEW



PROPOSED BIRDS EYE VIEW LOOKING WEST



PROPOSED EYE LEVEL VIEW LOOKING SOUTH-WEST

PROPOSED 3D MODEL IMAGES

STATUS KEY			
Issue/Rev	Rev No.	Date	Comment
00	ISSUE FOR TENDER	-	-
01	COMPLETED	-	-
02	REVISION	-	-
03	FINAL APPROVAL	-	-
04	CONTRACTOR APPROVAL	-	-
05	ISSUE	-	-
06	CONTRACTOR DESIGN	-	-
PUBLISHED			
01	FOR TENDER	-	-
02	CONSTRUCTION	-	-
03	AS-BUILT	-	-



ARCHITECTS DEPARTMENT
MAYO COUNTY COUNCIL



Project No:	CSMDICG003	Project Title:	RISE OF THE WATERS' PUBLIC REALM PROJECT AT CONG, CO. MAYO	Draw Type:	-	Status:	S2
Drawing Title:	PROPOSED 3D MODEL IMAGES	Drawing No.:	5203	Revised:	-	Scale:	N/A
Drawn By:	DC	Chk:	MS	Level:	MS	Print Issue:	15.04.2020
Checked By:	MS	Category:	CSMDICG003 - MCC - XX - XI - DR - A - 5203 - S2				



Do not scale this drawing. Written dimensions only to be used.

- Scales as stated are valid on the original drawing only. Written dimensions take precedence. Detail dimensions take precedence over plan dimensions.
- Notify architect of any dimensional discrepancies. Any modifications or deviation to be brought to the attention of the architect for review and approval.
- All vertical dimensions shall be taken from a "bench mark" or other similar guide established prior to the start of construction. High points, low points, irregularities in floor slab which could affect fabrication / installation, work of other trades or vendors shall be brought to the attention of Mayo County Council Architects immediately.
- All drawings are to be read in conjunction with other consultant's drawings.
- All dimensions, unless otherwise stated, are given in millimetres and must be confirmed and checked by the Contractor on site.
- Levels are generally given in metres from a specified datum.
- All Levels must be confirmed and checked by the Contractor on site.
- Any discrepancies on this drawing are to be brought to the attention of Mayo County Council Architects immediately.

Includes Ordnance Survey Ireland data reproduced under OS licence number : NMA 2021 / MAYO COUNTY COUNCIL

Unauthorised reproduction infringes Ordnance Survey Ireland and Government of Ireland copyright Ordnance Survey Ireland.



PROPOSED BIRDS EYE LOOKING NORTH-EAST



PROPOSED EYE LEVEL VIEW LOOKING NORTH-WEST



PROPOSED BIRDS EYE AERIAL VIEW

PROPOSED 3D MODEL IMAGES

STATUS KEY			
Symbol / Description	Rev. No.	Date	Comment
00	-	-	WORK IN PROGRESS
01	-	-	CONCEPT
02	-	-	PRELIMINARY
03	-	-	PROVISIONAL
04	-	-	CLIENT COMMENT
05	-	-	CLIENT APPROVAL
06	-	-	CONTRACTOR TENDER
07	-	-	CONTRACTOR DESIGN
08	-	-	CONTRACTOR CONSTRUCTION
09	-	-	AS BUILT



ARCHITECTS DEPARTMENT
MAYO COUNTY COUNCIL



Project No:	Project Title:	Draw Type:	Status:
C5M01CG003	RISING OF THE WATERS' PUBLIC REALM PROJECT AT CONG. CO. MAYO	-	S2
Drawn By:	Checked By:	Scale:	Print Issue:
DC	MS	N/A	15.04.2020

