

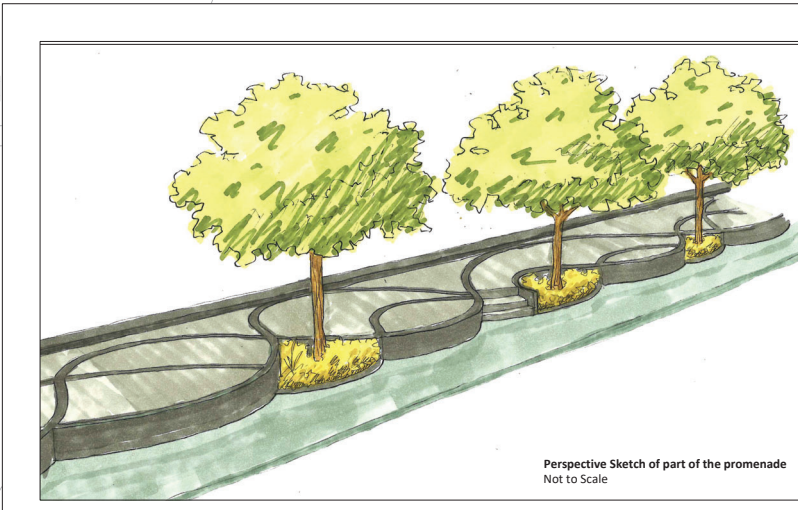

**Appendix**  
**19.3 Cathedral Road**  
**Raised Promenade**

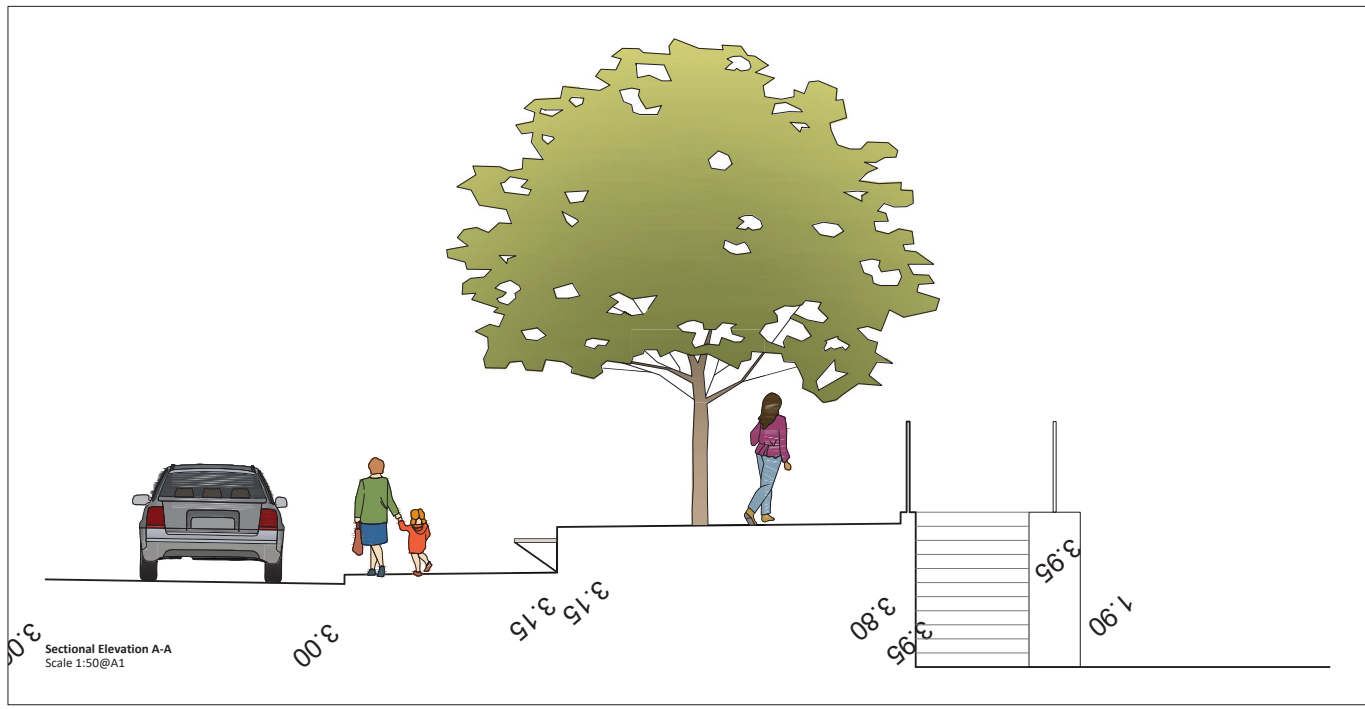

- Legend**
- Proposed lime trees to match existing
  - Existing tree to be retained
  - Proposed ornamental planting at footpath level
  - Footpath
  - Raised Promenade - Natural Stone Paving
  - Raised Promenade - Natural Stone Border
  - Street Furniture
  - Proposed wall
  - Existing wall

Client  
 Comhairle Contae Mhaigh Eo  
 Mayo County Council  
 OPW  
 Office of Public Works

General Notes  
 (i) This drawing is the property of RPS Consulting Engineers, it is a confidential document and must not be copied, used, or its content divulged without prior written consent.  
 (ii) All Levels refer to Ordnance Survey Datum, Main Head.  
 (iii) DO NOT SCALE, use figured dimensions only, if in doubt ask.  
 (iv) Hard copies, dxf and pdf will form a controlled issue of the drawing. All other formats (dwg etc) are deemed to be an uncontrolled issue and any work carried out based on these files is at the recipient's own risk. RPS will not accept any responsibility for any errors from the use of these files, either by human error by the recipient, listing of the un-dimensioned measurements, compatibility with the recipient's software, and any errors arising when these files are used to aid the recipient's drawing production, or setting out on site.

Rev	Date	By	App	Amendment / Issue
02	01.11.24	MM	MM	Final for Submission
01	01.09.23	PC	PC	Addition of Visualisations

RPS  
 Model File Identifier  
 MGW0290-RPS-00-XX-DR-L-LA0001

Scale  
 1:250 @ A1  
 1:500 @ A3  
 Created on  
 July 2023  
 Sheets  
 2 of 2

Project		Title		Status	Rev
Ballina Flood Relief Scheme		Cathedral Road Raised Promenade		S4	P01.02
File Identifier	Drawing No.	Status	Rev		
MGW0290-RPS-00-XX-DR-L-LA0001	02	S4	P01.02		