

CO. MAYO  
Ballina

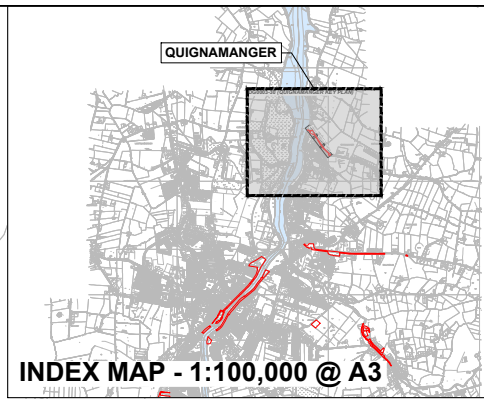
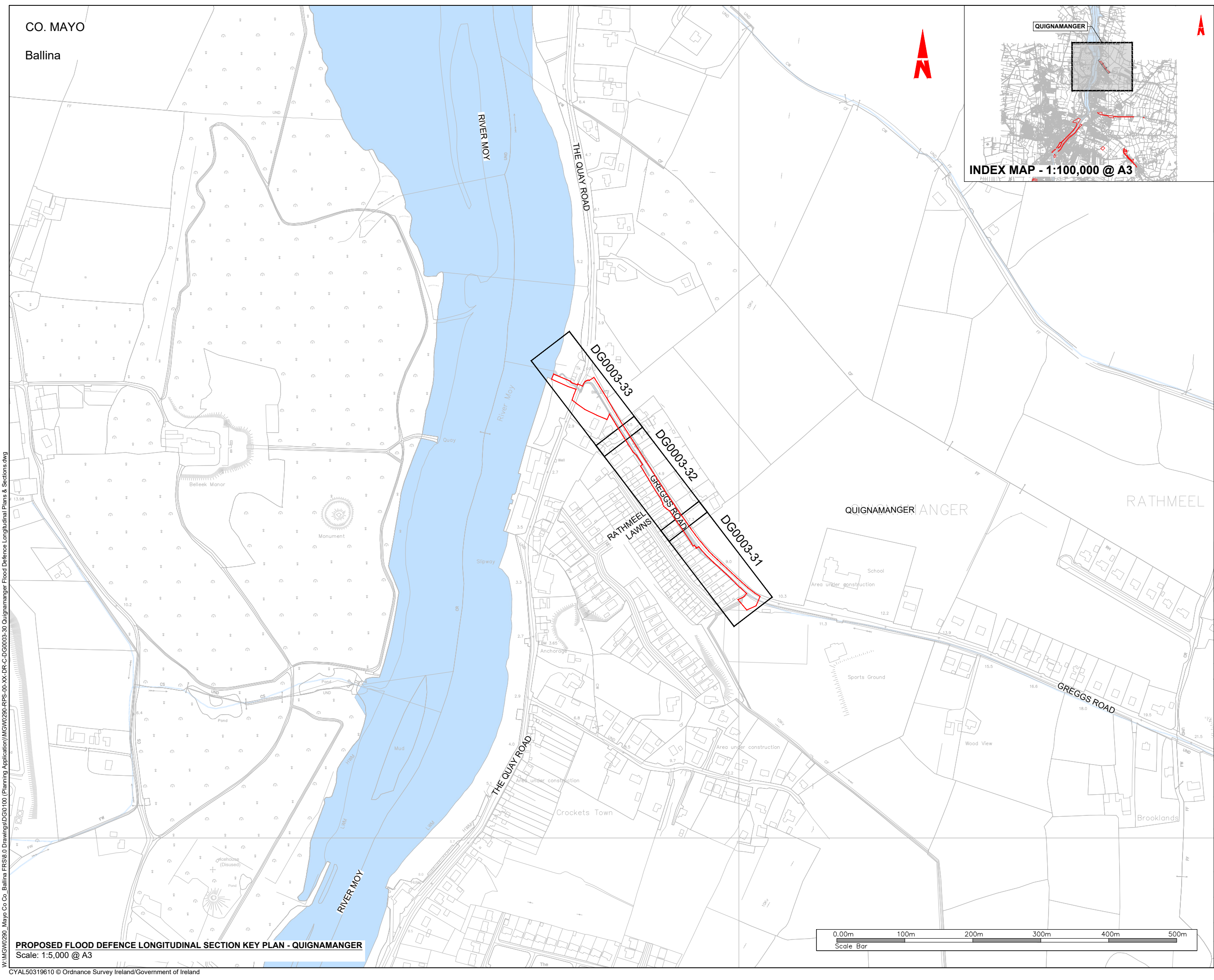

**General Notes**

- (i) Hard copies, dwf and pdf will form a controlled issue of the drawing. All other formats (dwg etc.) are deemed to be an uncontrolled issue and any work carried out based on these files is at the recipients own risk. RPS will not accept any responsibility for any errors from the use of these files, either by human error by the recipient, listing of the un-dimensioned measurements, compatibility with the recipients software, and any errors arising when these files are used to aid the recipients drawing production, or setting out on site.
- (ii) DO NOT SCALE, use figured dimensions only.
- (iii) This drawing is the property of RPS, it is a project confidential classified document. It must not be copied used or its contents divulged without prior written consent. The needs and expectations of client and RPS must be considered when working with this drawing.
- (iv) Information including topographical survey, geotechnical investigation and utility detail used in the design have been provided by others.
- (v) All Levels refer to Ordnance Survey Datum, Malin Head.

**LEGEND:**  
PROPOSED REDLINE BOUNDARY ———

- FOR LAYOUT PLANS, REFER TO DG0003-10 SERIES
- FOR LOCATION PLANS, REFER TO DG0003-00 SERIES
- FOR PROPOSED FLOOD DEFENCE CROSS SECTIONS, REFER TO DG0003-50 SERIES

Rev	Date	Drawn By	Checked By	Amendment / Issue	App
A1	01/07/2025	SP	MM	AUTHORISED & ACCEPTED FOR PLANNING	R/S
02	27/03/25	SP	MM	REVIEW & AUTHORISATION	R/S
S4	P01 20/01/25	SP	MM	REVIEW & AUTHORISATION	R/S

Client

Comhairle Contae Mhaigh Eo  
Mayo County Council

Lyrr 2, IDA Business & Technology Park, Mervue, Galway  
T +353 91 400200  
W www.rpsgroup.com/ireland  
E ireland@rpsgroup.com

Project  
**BALLINA FLOOD RELIEF SCHEME PLANNING APPLICATION**

Title  
**PROPOSED FLOOD DEFENCE LONGITUDINAL SECTION KEY PLAN - QUIGNAMANGER**

Model File Identifier  
N/A

File Identifier  
MGW0290-RPS-00-XX-DR-C-DG0003-30

Created on  
20/11/2024

Scale  
1:2,500 @ A1  
1:5,000 @ A3

Sheets  
01 of 04

Status  
A1

Rev  
C01

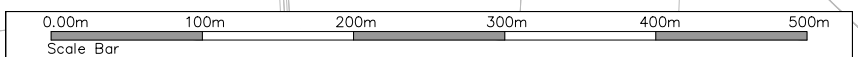

W:\MGW0290\_Mayo Co Co\_Ballina FRS16.0 Drawings\DG0100 (Planning Application)\MGW0290-RPS-00-XX-DR-C-DG0003-30 Quignamanger Flood Defence Longitudinal Plans & Sections.dwg

**PROPOSED FLOOD DEFENCE LONGITUDINAL SECTION KEY PLAN - QUIGNAMANGER**  
Scale: 1:5,000 @ A3

CO. MAYO

Ballina

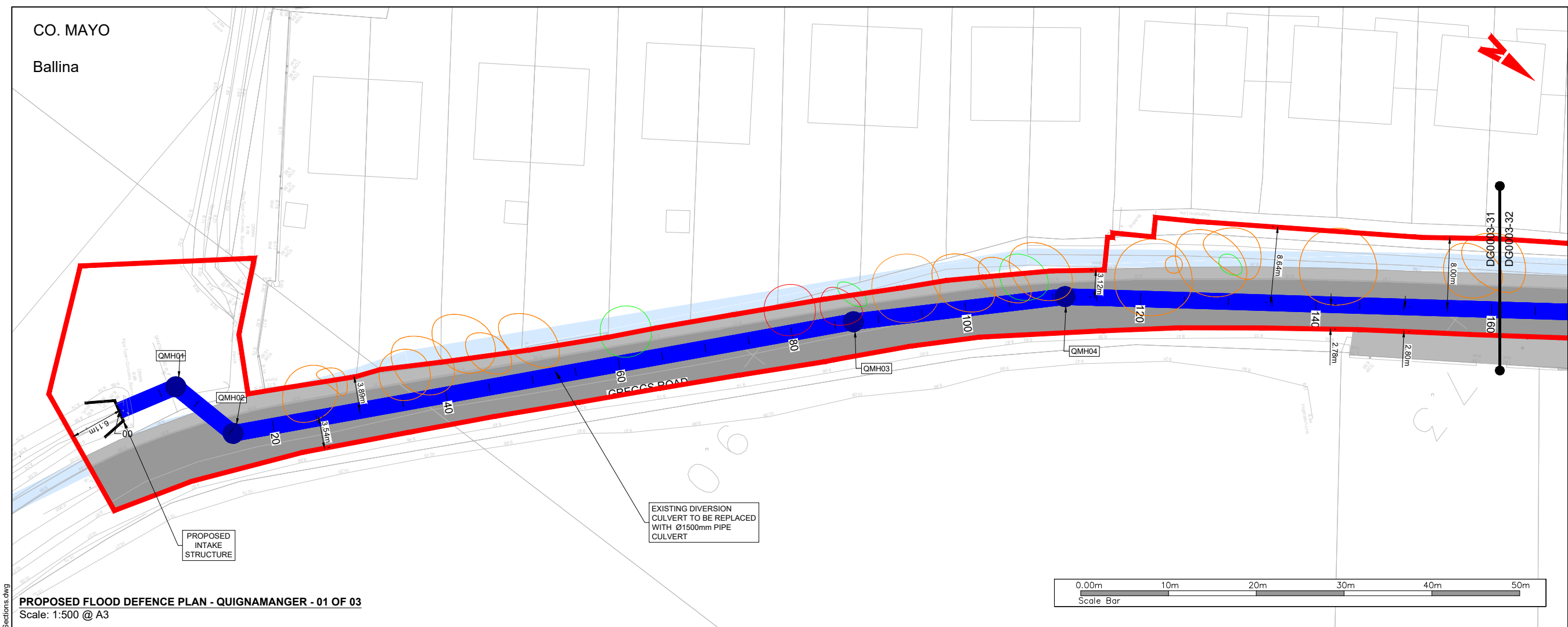

**PROPOSED FLOOD DEFENCE PLAN - QUIGNAMANGER - 01 OF 03**  
 Scale: 1:500 @ A3

**General Notes**

(i) Hard copies, dwf and pdf will form a controlled issue of the drawing. All other formats (dwg etc.) are deemed to be an uncontrolled issue and any work carried out based on these files is at the recipient's own risk. RPS will not accept any responsibility for any errors from the use of these files, either by human error by the recipient, listing of the un-dimensioned measurements, compatibility with the recipient's software, and any errors arising when these files are used to aid the recipient's drawing production, or setting out on site.

(ii) DO NOT SCALE, use figured dimensions only.

(iii) This drawing is the property of RPS, it is a project confidential classified document. It must not be copied or its contents divulged without prior written consent. The needs and expectations of client and RPS must be considered when working with this drawing.

(iv) Information including topographical survey, geotechnical investigation and utility detail used in the design have been provided by others.

(v) All Levels refer to Ordnance Survey Datum, Malin Head.

**LEGEND:**

- PROPOSED REDLINE BOUNDARY
- EXISTING GROUND LEVEL
- EXISTING WALL TO BE RECONSTRUCTED
- FLOOD WALL TO BE RETAINED
- PROPOSED FLOODGATE
- PROPOSED GLASS WALL
- PROPOSED RC FLOOD WALL
- PROPOSED TOE OF RC FLOOD WALL
- PROPOSED 1.5mØ CULVERT
- PROPOSED 2.0x1.0m CULVERT
- PROPOSED OPEN CHANNEL CLAD IN STONE
- EXISTING FOOTPATH
- EXISTING ROAD
- PROPOSED NATURAL STONE PAVING
- PROPOSED REPURPOSED CONCRETE BLOCK PAVING
- PROPOSED EMBANKMENT
- TREES TO BE RETAINED
- TREES REQUIRING REMOVAL DUE TO POOR HEALTH
- TREES REQUIRING REMOVAL DUE TO CONSTRUCTION
- NEW TREES TO BE PLANTED

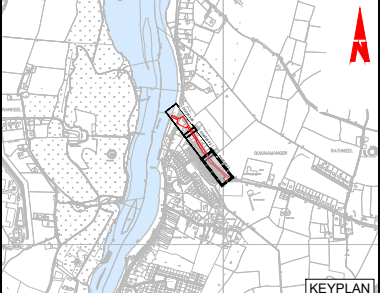

• FOR LAYOUT PLANS, REFER TO DG0003-10 SERIES  
 • FOR LOCATION PLANS, REFER TO DG0003-00 SERIES  
 • FOR PROPOSED FLOOD DEFENCE CROSS SECTIONS, REFER TO DG0003-50 SERIES

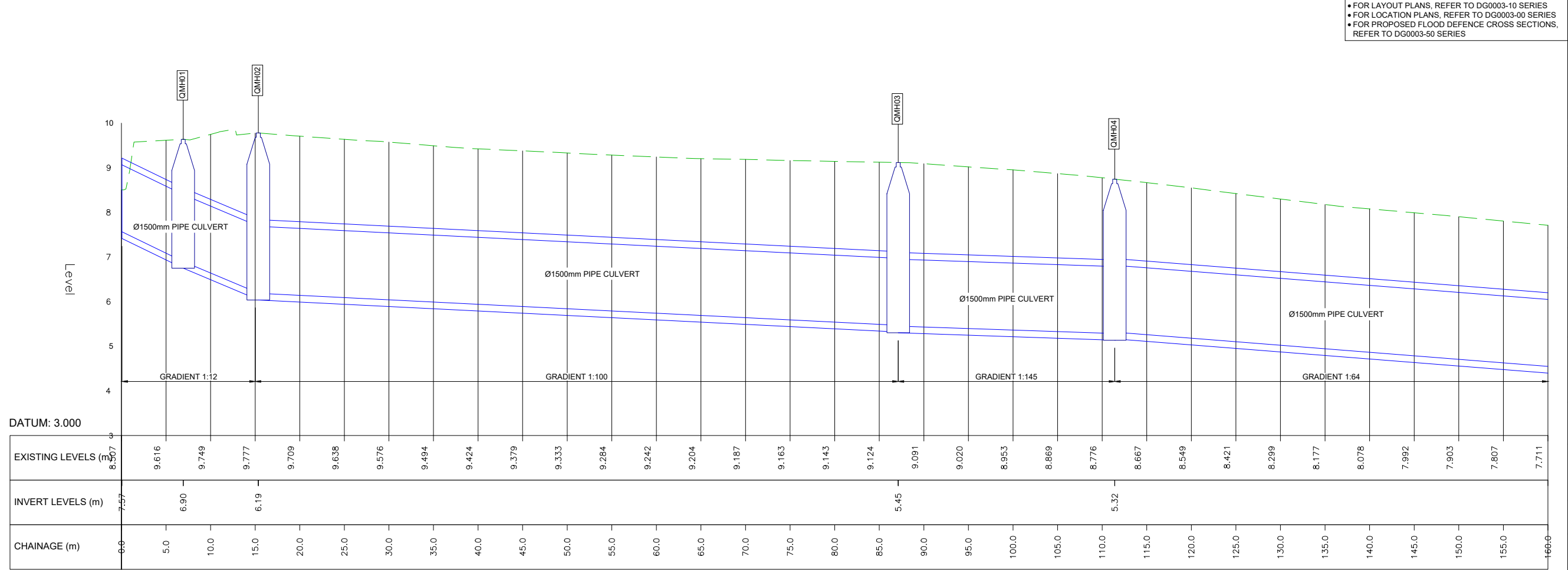

**PROPOSED FLOOD DEFENCE LONGITUDINAL SECTION - QUIGNAMANGER - 01 OF 03**  
 Scale: Horiz. 1:250, Vert. 1:50 @ A1  
 Scale: Horiz. 1:500, Vert. 1:100 @ A3

Rev	Date	Drawn By	Checked By	Amendment / Issue	App
A1	01/07/2025	MM	MM	AUTHORISED & ACCEPTED FOR PLANNING	RJS
P02	27/03/25	MM	MM	REVIEW & AUTHORISATION	RJS
S4 P01	20/01/25	MM	MM	REVIEW & AUTHORISATION	RJS

Client

Comhairle Contae Mhaigh Eo  
Mayo County Council

OPW  
Office of Public Works

**RPS** MAKING COMPLEX EASY

Lynn 2, IDA Business & Technology Park, Mervue, Galway  
 T +353 91 400200  
 W www.rpsgroup.com/ireland  
 E ireland@rpsgroup.com

Project  
**BALLINA FLOOD RELIEF SCHEME PLANNING APPLICATION**

Title  
**PROPOSED FLOOD DEFENCE PLAN & LONGITUDINAL SECTION - QUIGNAMANGER (01 of 03)**

Model File Identifier  
 N/A

File Identifier  
 MGW0290-RPS-00-XX-DR-C-DG0003-31

Created on 20/11/2024	Sheets 02 of 04
Scale AS STATED @ A1 AS STATED @ A3	Status A1
	Rev C01

W:\MGW0290\_Mayo Co Co\_Ballina FRS16.0 Drawings\0100 (Planning Application)\MGW0290-RPS-00-XX-DR-C-DG0003-30 Quignamanger Flood Defence Longitudinal Plane & Sections.dwg

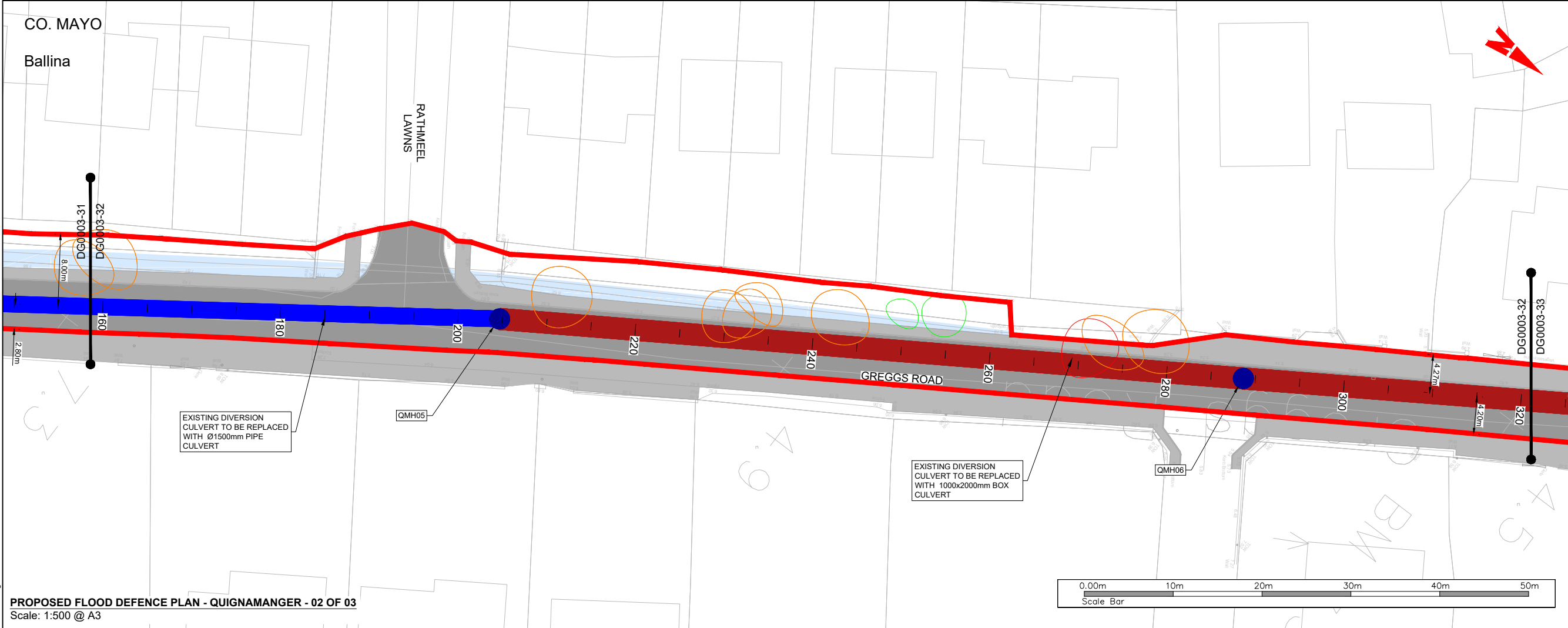

**General Notes**

- Hard copies, dwf and pdf will form a controlled issue of the drawing. All other formats (dwg etc.) are deemed to be an uncontrolled issue and any work carried out based on these files is at the recipients own risk. RPS will not accept any responsibility for any errors from the use of these files, either by human error by the recipient, listing of the un-dimensioned measurements, compatibility with the recipients software, and any errors arising when these files are used to aid the recipients drawing production, or setting out on site.
- DO NOT SCALE, use figured dimensions only.
- This drawing is the property of RPS, it is a project confidential classified document. It must not be copied used or its contents divulged without prior written consent. The needs and expectations of client and RPS must be considered when working with this drawing.
- Information including topographical survey, geotechnical investigation and utility detail used in the design have been provided by others.
- All Levels refer to Ordnance Survey Datum, Malin Head.

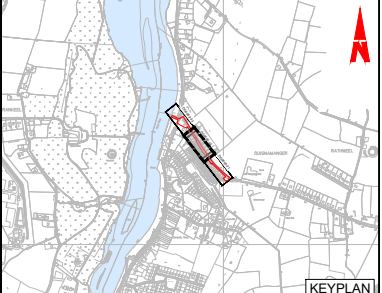

**LEGEND:**

PROPOSED REDLINE BOUNDARY	
EXISTING GROUND LEVEL	
EXISTING WALL TO BE RECONSTRUCTED	
FLOOD WALL TO BE RETAINED	
PROPOSED FLOODGATE	
PROPOSED GLASS WALL	
PROPOSED RC FLOOD WALL	
PROPOSED TOE OF RC FLOOD WALL	
PROPOSED 1.5mØ CULVERT	
PROPOSED 2.0x1.0m CULVERT	
PROPOSED OPEN CHANNEL CLAD IN STONE	
EXISTING FOOTPATH	
EXISTING ROAD	
PROPOSED NATURAL STONE PAVING	
PROPOSED REPURPOSED CONCRETE BLOCK PAVING	
PROPOSED EMBANKMENT	
TREES TO BE RETAINED	
TREES REQUIRING REMOVAL DUE TO POOR HEALTH	
TREES REQUIRING REMOVAL DUE TO CONSTRUCTION	
NEW TREES TO BE PLANTED	

**PROPOSED FLOOD DEFENCE PLAN - QUIGNAMANGER - 02 OF 03**  
Scale: 1:500 @ A3

• FOR LAYOUT PLANS, REFER TO DG0003-10 SERIES  
• FOR LOCATION PLANS, REFER TO DG0003-00 SERIES  
• FOR PROPOSED FLOOD DEFENCE CROSS SECTIONS, REFER TO DG0003-50 SERIES

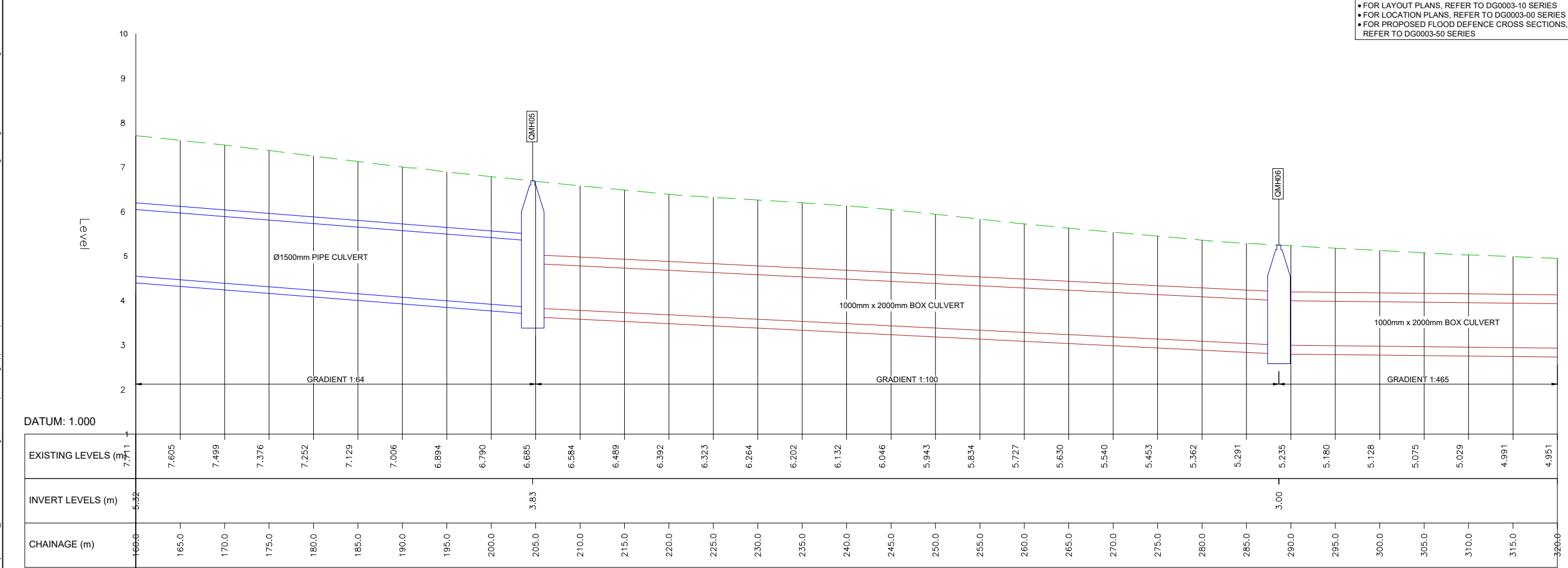

**PROPOSED FLOOD DEFENCE LONGITUDINAL SECTION - QUIGNAMANGER - 02 OF 03**  
Scale: Horiz. 1:250, Vert. 1:50 @ A1  
Scale: Horiz. 1:500, Vert. 1:100 @ A3

Rev	Date	Drawn By	Checked By	Amendment / Issue	App
A1	07/04/25	RP	MM	AUTHORISED & ACCEPTED FOR PLANNING	RS
P02	27/03/25	RP	MM	REVIEW & AUTHORISATION	RS
S4	20/01/25	RP	MM	REVIEW & AUTHORISATION	RS

**Client**

Comhairle Contae Mhaigh Eo  
Mayo County Council

**OPW**  
Office of Public Works

**RPS** MAKING COMPLEX EASY

Lyrr 2, IDA Business & Technology Park, Mervue, Galway  
T +353 91 400200  
W www.rpsgroup.com/ireland  
E ireland@rpsgroup.com

**Project**  
**BALLINA FLOOD RELIEF SCHEME PLANNING APPLICATION**

**Title**  
**PROPOSED FLOOD DEFENCE PLAN & LONGITUDINAL SECTION - QUIGNAMANGER (02 of 03)**

**Model File Identifier**  
N/A

**File Identifier**  
MGW0290-RPS-00-XX-DR-C-DG0003-32

<b>Created on</b> 20/11/2024	<b>Sheets</b> 03 of 04
<b>Scale</b> AS STATED @ A1 AS STATED @ A3	<b>Status</b> A1
	<b>Rev</b> C01

CO. MAYO

Ballina

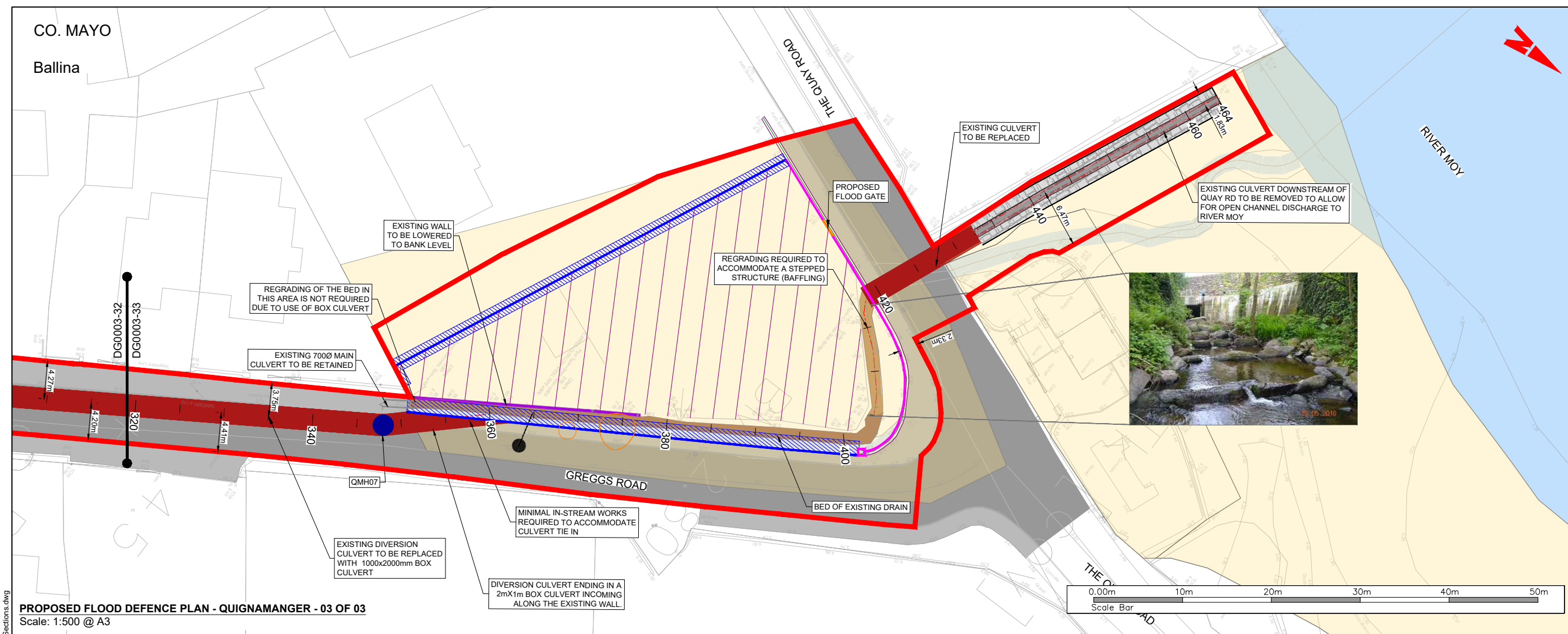

**PROPOSED FLOOD DEFENCE PLAN - QUIGNAMANGER - 03 OF 03**  
Scale: 1:500 @ A3

**General Notes**

- (i) Hard copies, dwf and pdf will form a controlled issue of the drawing. All other formats (dwg etc.) are deemed to be an uncontrolled issue and any work carried out based on these files is at the recipients own risk. RPS will not accept any responsibility for any errors from the use of these files, either by human error by the recipient, listing of the un-dimensioned measurements, compatibility with the recipients software, and any errors arising when these files are used to aid the recipients drawing production, or setting out on site.
- (ii) DO NOT SCALE, use figured dimensions only.
- (iii) This drawing is the property of RPS, it is a project confidential classified document. It must not be copied used or its contents divulged without prior written consent. The needs and expectations of client and RPS must be considered when working with this drawing.
- (iv) Information including topographical survey, geotechnical investigation and utility detail used in the design have been provided by others.
- (v) All Levels refer to Ordnance Survey Datum, Malin Head.

(i) Hard copies, dwf and pdf will form a controlled issue of the drawing. All other formats (dwg etc.) are deemed to be an uncontrolled issue and any work carried out based on these files is at the recipients own risk. RPS will not accept any responsibility for any errors from the use of these files, either by human error by the recipient, listing of the un-dimensioned measurements, compatibility with the recipients software, and any errors arising when these files are used to aid the recipients drawing production, or setting out on site.

(ii) DO NOT SCALE, use figured dimensions only.

(iii) This drawing is the property of RPS, it is a project confidential classified document. It must not be copied used or its contents divulged without prior written consent. The needs and expectations of client and RPS must be considered when working with this drawing.

(iv) Information including topographical survey, geotechnical investigation and utility detail used in the design have been provided by others.

(v) All Levels refer to Ordnance Survey Datum, Malin Head.

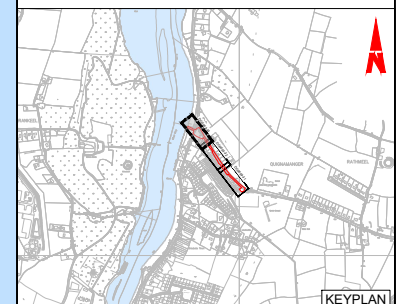

**LEGEND:**

PROPOSED REDLINE BOUNDARY	
EXISTING GROUND LEVEL	
EXISTING WALL TO BE RECONSTRUCTED	
FLOOD WALL TO BE RETAINED	
PROPOSED FLOODGATE	
PROPOSED GLASS WALL	
PROPOSED RC FLOOD WALL	
PROPOSED TOE OF RC FLOOD WALL	
PROPOSED 1.5mØ CULVERT	
PROPOSED 2.0x1.0m CULVERT	
PROPOSED OPEN CHANNEL CLAD IN STONE	
EXISTING FOOTPATH	
EXISTING ROAD	
PROPOSED NATURAL STONE PAVING	
PROPOSED REPURPOSED CONCRETE BLOCK PAVING	
PROPOSED EMBANKMENT	
TREES TO BE RETAINED	
TREES REQUIRING REMOVAL DUE TO POOR HEALTH	
TREES REQUIRING REMOVAL DUE TO CONSTRUCTION	
NEW TREES TO BE PLANTED	

• FOR LAYOUT PLANS, REFER TO DG0003-10 SERIES  
• FOR LOCATION PLANS, REFER TO DG0003-00 SERIES  
• FOR PROPOSED FLOOD DEFENCE CROSS SECTIONS, REFER TO DG0003-50 SERIES

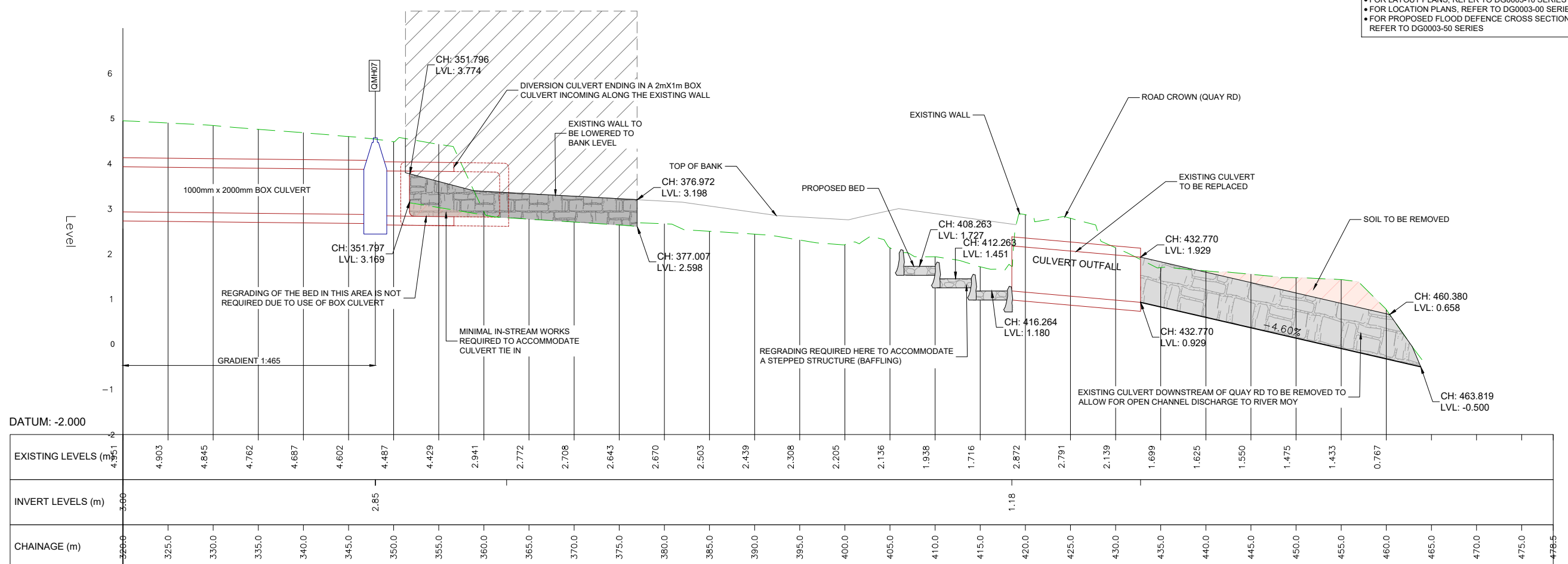

**PROPOSED FLOOD DEFENCE LONGITUDINAL SECTION - QUIGNAMANGER - 03 OF 03**  
Scale: Horiz. 1:250, Vert. 1:50 @ A1  
Scale: Horiz. 1:500, Vert. 1:100 @ A3

Rev	Date	Drawn/Checked	Amendment / Issue	App
A1	07/04/25	MM/MS	AUTHORISED & ACCEPTED FOR PLANNING	RS
02	27/03/25	MM/MS	REVIEW & AUTHORISATION	RS
S4	20/01/25	MM/MS	REVIEW & AUTHORISATION	RS

Client

Comhairle Contae Mhaigh Eo Mayo County Council

OPW

**RPS** MAKING COMPLEX EASY

Lyrr 2, IDA Business & Technology Park, Mervue, Galway  
T +353 91 400200  
W www.rpsgroup.com/ireland  
E ireland@rpsgroup.com

Project  
**BALLINA FLOOD RELIEF SCHEME PLANNING APPLICATION**

Title  
**PROPOSED FLOOD DEFENCE PLAN & LONGITUDINAL SECTION - QUIGNAMANGER (03 of 03)**

Model File Identifier  
N/A

File Identifier  
MGW0290-RPS-00-XX-DR-C-DG0003-33

Created on  
20/11/2024

Scale  
AS STATED @ A1  
AS STATED @ A3

Sheets  
04 of 04

Status  
A1

Rev  
C01

W:\MGW0290\_Mayo Co Co\_Ballina FRS16.0 Drawings\0100 (Planning Application)\MGW0290-RPS-00-XX-DR-C-DG0003-33\_Quignamanger Flood Defence Longitudinal Plane & Sections.dwg